

**GUBOX**

Explosion Proof and Dust-Ignition Proof Classified Enclosure in Aluminum

8265/6 Enclosure



Contents

| | | |
|-----|--|----|
| 1 | General Information | 2 |
| 1.1 | Manufacturer | 2 |
| 1.2 | Information regarding this Installation, Operation and Maintenance Sheet | 2 |
| 1.3 | Symbols Used | 3 |
| 2 | General Safety Notes | 3 |
| 2.1 | Safety Instructions for Assembly and Operating Personnel | 3 |
| 2.2 | Warning notes | 4 |
| 2.3 | Hazardous Location Ratings and Applicable Standards | 4 |
| 3 | Application | 4 |
| 4 | Technical data | 5 |
| 5 | Installation | 7 |
| 6 | Drilling and Tapping of Entries | 8 |
| 7 | Grounding and Bounding | 12 |
| 8 | Maintenance | 13 |
| 8.1 | Regular maintenance work | 13 |
| 8.2 | Cleaning | 13 |
| 9 | Accessories and Spare parts | 13 |

1 General Information

1.1 Manufacturer

R. STAHL Schaltgeräte GmbH
Am Bahnhof 30
74638 Waldenburg
Germany

Tel.: +49 7942 943-0
Fax: +49 7942 943-4333
Internet: www.stahl-ex.com
E-Mail: info@stahl.de







R. STAHL, INC.
13259 N. Promenade Blvd.
Stafford, TX 77477
USA

Phone: +1 800 782-4357
Fax: +1 281 313-9302
Internet: www.rstahl.com
E-Mail: sales@rstahl.com

1.2 Information regarding this Installation, Operation and Maintenance Sheet

ID-No.: 165784 / 826560300020
Publication Code: 2016-12-12·IOMUS·III·en-US·04
Subject to alterations.

1.3 Symbols Used

| | |
|---|--|
|  | Action request: Describes actions to be carried out by the user. |
|  | Reaction sign: Describes the results or the reactions to the actions taken. |
|  | Bullet |
|  | Information sign: Describes notes and recommendations. |
|  | Warning symbol; danger due to energised parts! |
|  | Warning symbol: danger due to explosive atmosphere! |

2 General Safety Notes

2.1 Safety Instructions for Assembly and Operating Personnel

The Installation, Operation and Maintenance Sheet contains basic safety instructions which are to be observed during installation, operation and maintenance.

Failure to follow this document and manufacturer's recommendations can lead to persons, equipment and the environment being endangered.

WARNING

Risk due to unauthorized work being performed on the device!

- ▷ There is a risk of injury and damage to equipment.
- ▶ Mounting, installation, commissioning and servicing work must only be performed by personnel who are both authorized and suitably trained for this purpose.

Before assembly/putting into service:

- Read through the operating instructions completely.
- Give adequate training to the assembly and operating personnel.
- Ensure that the contents of the operating instructions are fully understood by the personnel in charge, and those performing the work.
- The national and local installation and assembly regulations apply.

If you have questions:

- Contact the manufacturer.

When operating the devices:

- Ensure the operating instructions are made available on location at all times.
- Observe safety instructions.
- Observe national and local safety and accident prevention regulations.
- Only run the device according to its performance data.
- Servicing/maintenance work or repairs which are not described in the operating instructions must not be performed without prior agreement with the manufacturer.
- Any damage may render explosion protection null and void.
- No changes to the devices or components impairing their explosion protection are permitted.
- The device may only be fitted and used if it is in an undamaged, dry and clean state.

2.2 Warning notes

Warnings are sub-divided in these operating instructions according to the following scheme:

|  WARNING |
|--|
| Type and source of the danger! |
| ▷ Possible consequences. |
| ▶ Measures for avoiding the danger. |

They are always identified by the signalling word "WARNING" and sometimes also have a symbol which is specific to the danger involved.

2.3 Hazardous Location Ratings and Applicable Standards

The explosion proof and dust-ignition proof enclosures are in compliance with the following standards:

| | |
|------------------|--|
| UL 50 | Enclosures for Electrical Equipment |
| UL 2062 | Enclosures for Use in Hazardous (Classified) Locations |
| UL 1203 | Explosion-Proof and Dust-Ignition-Proof Electrical Equipment for Use in Hazardous (Classified) Locations |
| CSA C22.2-No. 25 | Enclosures for Use in Class II Groups E, F and G Hazardous Locations |
| CSA C22.2-No. 30 | Explosion-Proof Enclosures for Use in Class I Hazardous Locations Industrial Products |

3 Application

The enclosures are used to build motor starters, control stations and terminal boxes. Furthermore they are suitable for measuring equipment and customer specific control units.

The enclosures are designed for use in Class I, Div. 1, Groups A, B, C & D; Class II, Div. 1, Groups E, F & G and Class III hazardous (classified) locations as defined by the National Electrical Code (NFPA70) and the Canadian Electrical Code (CEC).

Covers with windows and O-Ring seals together with mounting plates and DIN rails are available to complete the series of enclosures.

For direct cable entry, flameproof cable glands (Div. 2 or Zone 1 only) or threaded entries for direct conduit connection can be applied. For cable installation suitable glands and cable need to be used.

| |
|---|
| ⚠ WARNING |
| <p>Only use the device for its intended purpose!</p> <ul style="list-style-type: none"> ▷ Otherwise, the manufacturer's liability and warranty expire. ▶ Only use the device under the operating conditions described in the operating instructions. |

4 Technical data

Technical Data

| | |
|---|--|
| <p>Gas explosion protection</p> <p>Dust explosion protection</p> <p>Certificate</p> | <p>Class I, Division 1, Groups A, B, C & D Class I, Zone 1, Group IIC</p> <p>Class II, Division 1, Groups E, F & G Class III</p> <div style="text-align: center;">  <p>UL-File E307783</p> </div> |
| <p>Type rating</p> <p>Enclosure material</p> | <p>3, 4, 4x, 7 and 9</p> <p>Aluminum, copper free (Marine Grade)</p> |

Dimension drawings - subject to alterations

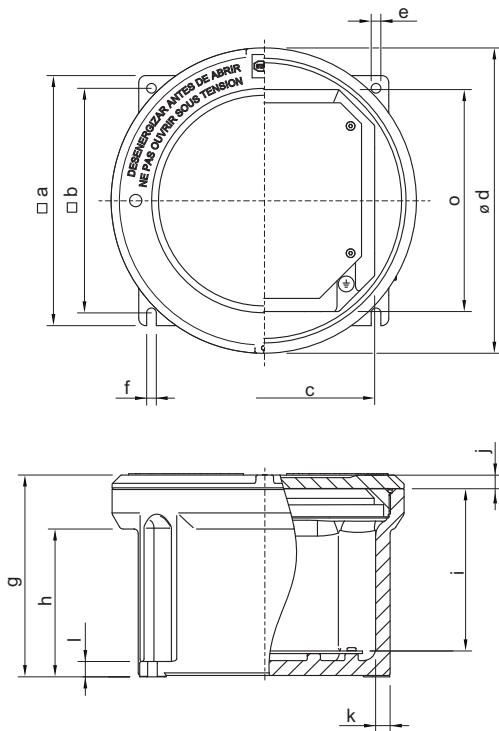

18805E00

Enclosure 8265/6.-000.
without window

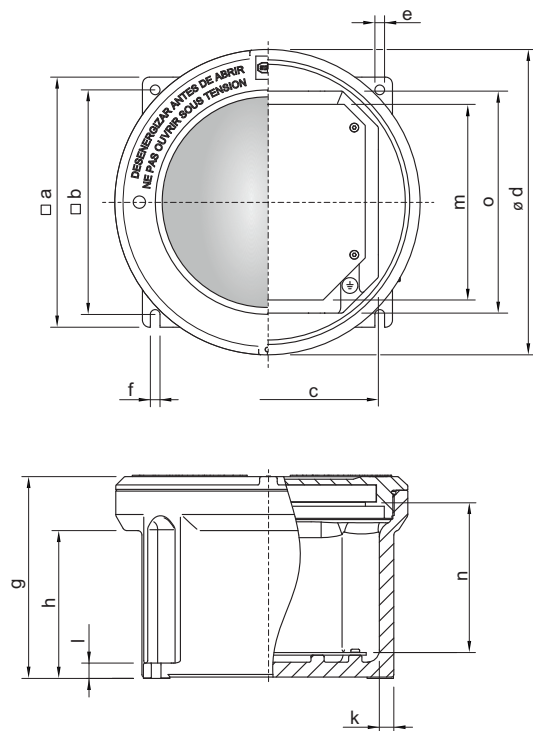









18806E00

Enclosure 8265/6.-001.
with window

| Dimensions in inch (mm) | | | | | | | | | | | | | | | |
|-------------------------|-------|-------|-------|-------|--------|--------|-------|---------|---------|------|------------------------------|--------|---------|---------|-------|
| Type | a | b | c | d | e | f | g | h | i | j | k | l | m | n | o |
| 8265/61 | 4.92 | 4.33 | 4.29 | 5.91 | 0.23 | 0.23 | 5.20 | 3.21 | 3.60 | 0.51 | side AB 0.31 side CD 0.51 | 0.41 | 2.11 | 3.24 | 3.90 |
| | [125] | [110] | [109] | [150] | [5.8] | [5.8] | [132] | [81.5] | [91.5] | [13] | side AB [8] side CD [13] | [10.5] | [53.5] | [82.2] | [99] |
| 8265/62 | 6.10 | 5.51 | 5.08 | 7.56 | 0.28 | 0.28 | 5.20 | 3.05 | 3.62 | 0.51 | 0.51 | 0.45 | 3.64 | 3.26 | 5.08 |
| | [155] | [140] | [129] | [192] | [7] | [7] | [132] | [77.5] | [92] | [13] | [13] | [11.5] | [92.5] | [83] | [129] |
| 8265/63 | 7.68 | 6.77 | 6.65 | 9.21 | 0.35 | 0.35 | 6.77 | 4.62 | 5.20 | 0.51 | 0.51 | 0.61 | 5.14 | 4.80 | 6.65 |
| | [195] | [172] | [169] | [234] | [9] | [9] | [172] | [117.5] | [132] | [13] | [13] | [15.5] | [130.5] | [122] | [169] |
| 8265/64 | 9.29 | 8.27 | 8.23 | 11.38 | 0.43 | 0.43 | 8.94 | 6.63 | 7.26 | 0.51 | 0.53 | 0.65 | 7.09 | 6.68 | 8.23 |
| | [236] | [210] | [209] | [289] | [11] | [11] | [227] | [168.5] | [184.5] | [13] | [13.5] | [16.5] | [180] | [169.7] | [209] |
| 8265/65 | 11.22 | 10.08 | 9.96 | 13.70 | 0.43 | 0.43 | 9.06 | 6.63 | 7.15 | 0.63 | 0.63 | 0.69 | 7.09 | 6.56 | 9.96 |
| | [285] | [256] | [253] | [348] | [11] | [11] | [230] | [168.5] | [181.5] | [16] | [16] | [17.5] | [180] | [166.7] | [253] |
| 8265/66 | 13.19 | 12.13 | 11.81 | 16.14 | 0.45 | 0.45 | 11.06 | 8.13 | 9.04 | 0.71 | 0.69 | 0.61 | 7.09 | 8.37 | 11.81 |
| | [335] | [312] | [300] | [410] | [11.5] | [11.5] | [281] | [206.5] | [229.5] | [18] | [17.5] | [15.5] | [180] | [212.7] | [300] |

5 Installation

| | |
|--|---|
|  WARNING | |
|  | <p>Danger from energised parts!</p> <ul style="list-style-type: none"> ▷ Risk of severe injuries. ▷ Before any maintenance work commences, disconnect the device from the power supply. ▷ Secure the device against unauthorised activation. |
|  WARNING | |
| <p>Installation may only be performed by qualified personnel!</p> <ul style="list-style-type: none"> ▷ Installation work may only be performed by authorized personnel suitably trained for this purpose. ▷ Follow all applicable national and local regulations. | |
|  WARNING | |
|  | <p>Use of cable glands without cable strain-reliefs!</p> <ul style="list-style-type: none"> ▷ Explosion protection cannot be guaranteed any more if cable glands are installed without cable strain-reliefs in the vicinity of loosely laid cables and leads. ▷ Securely lay cabling and leads. ▷ If installation is to take place in areas with loosely laid cables, only use cable glands that are approved for this application. |
|  WARNING | |
|  | <p>Danger through damaged threads!</p> <ul style="list-style-type: none"> ▷ If threads are damaged, the necessary flame path for explosion protection is not guaranteed. ▷ Handle the cover with extreme care and fit it carefully to the enclosure. ▷ Replace a cover or enclosure with damaged threads immediately! |
|  | <p>The enclosures are furnished with or without drilled and tapped conduit openings. Drilling and tapping of openings is subject to the limitations of maximum size and number of openings as well as spacings and removed area. Refer to section "Drilling and Tapping of Entries". All machining must be done prior to installation.</p> |

- Select a mounting location that will provide suitable strength and rigidity for supporting all contained wiring and control devices (Mounting dimensions: see section "Technical Data").
- Securely fasten enclosure to the mounting location, then attach into wiring system.
- Unscrew enclosure cover and remove it carefully, set it aside to prevent damage to the cover threads.
- Pull wires into enclosure, making sure they are long enough to make the required connections. Make all electrical connections. Attach the cover to the enclosure, tighten cover carefully and secure it with the Set Screw.
- Conduit sealing must be installed within 18 inches of the enclosure.
- Pour sealing compound into sealing fittings (as required) in accordance with the supplied Instructions as well as the NEC and the CEC.
- All entry holes have to be closed by close-up plugs, conduit or cable fittings with the same listing (Class, Division, Groups) then the enclosure.

6 Drilling and Tapping of Entries

The minimum center-to-center distance (P) of tapped entries must be in accordance with the table below.

| |
|---|
| ⚠ WARNING |
| <ul style="list-style-type: none"> ▶ Additional spacing may be required if conduit fittings are located adjacent to each other. ▶ If reducers are used, the male thread of the reducer counts for spacing based on the thread size of the reducer, not the trade size of the conduit. |

| |
|--|
| ⚠ WARNING |
| <ul style="list-style-type: none"> ▶ Sealing fittings must be installed with access allowing the dams to be made and the sealing compound to be properly poured. ▶ To avoid interference of sealing fittings enlarge center-to-center distance (P) to account for fitting diameter. ▶ Recommended distance from the center of the entry to the edge of the entry area is P/2. |

| Minimum center-to-center distance "P" in inch (mm) between entries of different sizes | | | | | | | | |
|---|--|-----------------------|--|---------------------|---|---|----------------------------------|-------------------------|
| Metric or NPT | M10 x 1.5 M14 x 1.5 M15 x 1.5 M16 x 1.5 | M20 x 1.5 1/2" NPT | M24 x 1.5 M25 x 1.5 3/4" NPT 3/4"-14 NPSM | M32 x 1.5 1" NPT | M33 x 1.5 M36 x 1.5 M40 x 1.5 1-1/4" NPT 1-1/4"-11.5 NPSM | M42 x 1.5 M48 x 1.5 M50 x 1.5 1-1/2" NPT | M56 x 1.5 M63 x 1.5 2" NPT | M75 x 1.5 2-1/2" NPT |
| M10 x 1.5 M14 x 1.5 M15 x 1.5 M16 x 1.5 | 1.18 (30) | -- | -- | -- | -- | -- | -- | -- |
| M20 x 1.5 1/2" NPT | 1.18 (30) | 1.18 (30) | -- | -- | -- | -- | -- | -- |
| M24 x 1.5 M25 x 1.5 3/4" NPT 3/4"-14 NPSM | 1.38 (35) | 1.38 (35) | 1.57 (39.9) | -- | -- | -- | -- | -- |
| M32 x 1.5 1" NPT | 1.49 (37.8) | 1.49 (37.8) | 1.68 (42.7) | 1.79 (45.5) | -- | -- | -- | -- |
| M33 x 1.5 M36 x 1.5 M40 x 1.5 1-1/4" NPT 1-1/4"-11.5 NPSM | 1.68 (42.7) | 1.68 (42.7) | 1.88 (47.7) | 1.99 (50.5) | 2.18 (55.4) | -- | -- | -- |
| M42 x 1.5 M48 x 1.5 M50 x 1.5 1-1/2" NPT | 1.79 (45.5) | 1.79 (45.5) | 1.99 (50.5) | 2.10 (53.3) | 2.29 (58.2) | 3.35 (85.1) | -- | -- |
| M56 x 1.5 M63 x 1.5 2" NPT | 2.12 (53.8) | 2.12 (53.8) | 2.31 (58.8) | 2.43 (61.6) | 2.62 (66.5) | 2.73 (69.3) | 3.06 (77.6) | -- |
| M75 x 1.5 2-1/2" NPT | 3.38 (86.5) | 3.38 (86.5) | 2.58 (65.5) | 2.69 (68.3) | 2.88 (73.2) | 2.99 (76) | 3.32 (84.3) | 3.58 (91) |
| M90 x 1.5 M105 x 1.5 3" NPT | 2.99 (76) | 2.99 (76) | 3.19 (81) | 3.29 (83.5) | 3.53 (89.7) | 3.66 (93) | 4.13 (104.8) | 4.37 (111) |

P/2 is the half distance between two entries of the same size.

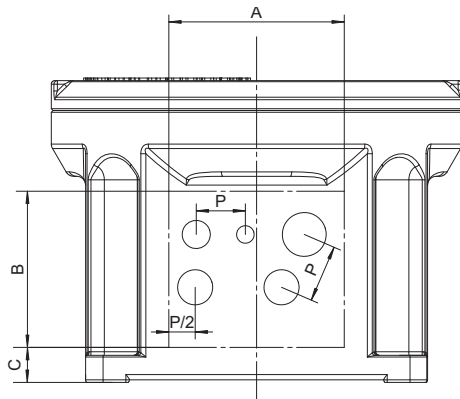

07221E00

| Area for Body Entry Installation | | | |
|----------------------------------|-----------------------|----------------------|---|
| Enclosure Type | Length A in inch (mm) | Width B in inch (mm) | Height over mounting surface C in inch (mm) |
| 8265/61 | 2.20 (56) | 2.20 (56) | 0.86 (22) |
| 8265/62 | 3.94 (100) | 1.89 (48) | 0.95 (24) |
| 8265/63 | 3.94 (100) | 3.50 (89) | 0.95 (24) |
| 8265/64 | 5.51 (140) | 5.35 (136) | 1.02 (26) |
| 8265/65 | 6.29 (160) | 5.11 (130) | 1.10 (28) |
| 8265/66 | 8.31 (211) | 6.58 (167) | 1.26 (32) |

| Maximal numbers of threaded entries at each side (NPT/NPSM) | | | | | | |
|---|---------|---------|---------|---------|---------|---------|
| Entry Size | 8265/61 | 8265/62 | 8265/63 | 8265/64 | 8265/65 | 8265/66 |
| 1/2" NPT | 2 | 4 | 9 | 18 | 12 | 39 |
| 3/4" NPT | 1 | 3 | 6 | 16 | 9 | 28 |
| 3/4" - 14 NPSM | 1 | 3 | 6 | 16 | 9 | 28 |
| 1" NPT | 1 | 2 | 5 | 9 | 6 | 20 |
| 1" NPSM | 1 | 2 | 5 | 9 | 6 | 20 |
| 1 - 1/4" NPT | 1 | 2 | 3 | 6 | 4 | 12 |
| 1 - 1/4" NPSM | -- | 2 | 3 | 6 | 4 | 12 |
| 1 - 1/2" NPT | -- | 1 | 2 | 4 | 3 | 8 |
| 2" NPT | -- | -- | 1 | 3 | 2 | 6 |
| 2 - 1/2" NPT | -- | -- | -- | -- | 1 | 4 |
| 3" NPT | -- | -- | -- | -- | 1 | 2 |

| Maximal number of metric entries at each side | | | | | | |
|---|---------|---------|---------|---------|---------|---------|
| Entry Size | 8265/61 | 8265/62 | 8265/63 | 8265/64 | 8265/65 | 8265/66 |
| M10 x 1.5; M14 x 1.5; M15 x 1.5; M16 x 1.5 | 2 | 3 | 8 | 16 | 18 | 48 |
| M20 x 1.5 | 1 | 3 | 8 | 16 | 18 | 28 |
| M24 x 1.5 | 1 | 2 | 4 | 9 | 9 | 28 |
| M25 x 1.5 | 1 | 2 | 4 | 9 | 9 | 16 |
| M32 x 1.5 | 1 | 2 | 3 | 6 | 8 | 11 |
| M33 x 1.5 | 1 | 1 | 2 | 4 | 5 | 11 |
| M36 x 1.5; M40 x 1.5 | -- | 1 | 2 | 4 | 5 | 8 |
| M42 x 1.5; M48 x 1.5 | -- | -- | 1 | 3 | 3 | 8 |
| M50 x 1.5 | -- | -- | 1 | 3 | 3 | 5 |
| M56 x 1.5 | -- | -- | 1 | 1 | 2 | 5 |
| M63 x 1.5 | -- | -- | 1 | 1 | 2 | 3 |
| M75 x 1.5 | -- | -- | 1 | 1 | 1 | 2 |
| M90 x 1.5; M105 x 1.5 | -- | -- | -- | -- | 1 | 1 |

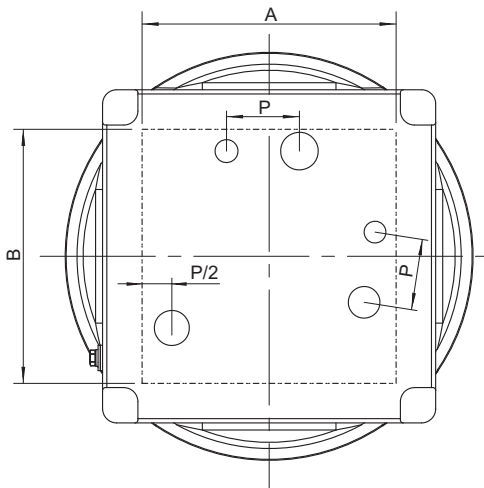

12807E

| Area for Floor Entry Installation | | |
|-----------------------------------|-----------------------|----------------------|
| Enclosure Type | Length A in inch (mm) | Width B in inch (mm) |
| 8265/61 | 3.15 (80) | 1.77 (45) |
| 8265/62 | 4.61 (117) | 2.44 (62) |
| 8265/63 | 6.02 (153) | 3.46 (88) |
| 8265/64 | 7.13 (181) | 5.59 (142) |
| 8265/65 | 7.87 (200) | 3.15 (80) |
| 8265/66 | 10.71 (272) | 5.87 (149) |

| Maximal numbers of threaded entries in Floor (NPT/NPSM) | | | | | | |
|---|---------|---------|---------|---------|---------|---------|
| Entry Size | 8265/61 | 8265/62 | 8265/63 | 8265/64 | 8265/65 | 8265/66 |
| 1/2" NPT | 2 | 2 | 3 | 5 | 5 | 5 |
| 3/4" NPT | 1 | 2 | 3 | 5 | 5 | 5 |
| 3/4" - 14 NPSM | 1 | 2 | 3 | 5 | 5 | 5 |
| 1" NPT | 1 | 1 | 1 | 2 | 2 | 2 |
| 1" NPSM | 1 | 1 | 1 | 2 | 2 | 2 |
| 1 - 1/4" NPT | 1 | 1 | 1 | 2 | 2 | 2 |
| 1 - 1/4" NPSM | -- | 1 | 1 | 2 | 2 | 2 |
| 1 - 1/2" NPT | -- | 1 | 1 | 1 | 1 | 1 |
| 2" NPT | -- | -- | 1 | 1 | 1 | 1 |
| 2 - 1/2" NPT | -- | -- | -- | 1 | 1 | 1 |
| 3" NPT | -- | -- | -- | -- | -- | 1 |

| Maximal number of metric entries in Floor | | | | | | |
|---|---------|---------|---------|---------|---------|---------|
| Entry Size | 8265/61 | 8265/62 | 8265/63 | 8265/64 | 8265/65 | 8265/66 |
| M10 x 1.5; M14 x 1.5; M15 x 1.5; M16 x 1.5 | 2 | 2 | 3 | 4 | 4 | 5 |
| M20 x 1.5; M24 x 1.5; M25 x 1.5 | 1 | 1 | 2 | 2 | 2 | 3 |
| M32 x 1.5; M33 x 1.5; M36 x 1.5 | -- | 1 | 1 | 2 | 2 | 3 |
| M40 x 1.5; M42 x 1.5; M48 x 1.5; M50 x 1.5; M56 x 1.5; M63 x 1.5 | -- | 1 | 1 | 1 | 1 | 1 |
| M75 x 1.5 | -- | -- | -- | -- | -- | 1 |

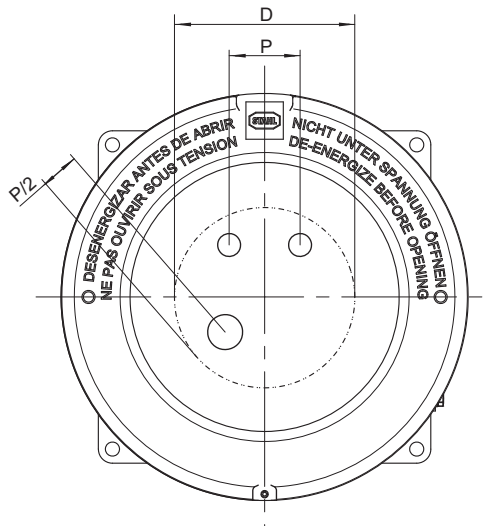

12806E

| Area for Cover Entry Installation | |
|-----------------------------------|-------------------------|
| Enclosure Type | Diameter D in inch (mm) |
| 8265/61 | 2.95 (75) |
| 8265/62 | 4.21 (107) |
| 8265/63 | 5.56 (143) |
| 8265/64 | 7.51 (191) |
| 8265/65 | 8.26 (210) |
| 8265/66 | 8.18 (208) |

| Maximal numbers of threaded entries in Cover (NPT/NPSM) | | | | | | |
|---|---------|---------|---------|---------|---------|---------|
| Entry Size | 8265/61 | 8265/62 | 8265/63 | 8265/64 | 8265/65 | 8265/66 |
| 3/4" - 14 NPSM | 1 | 2 | 3 | 5 | 8 | 8 |
| 1" NPSM | -- | -- | -- | -- | 3 | 5 |
| 1 - 1/4" NPSM | -- | -- | -- | -- | 3 | 5 |



| Maximal number of metric entries in Cover | | | | | | |
|---|---------|---------|---------|---------|---------|---------|
| Entry Size | 8265/61 | 8265/62 | 8265/63 | 8265/64 | 8265/65 | 8265/66 |
| M10 x 1.5; M14 x 1.5; M15 x 1.5; M16 x 1.5; M20 x 1.5 | 2 | 3 | 5 | 7 | 8 | 10 |
| M24 x 1.5; M25 x 1.5 | 1 | 2 | 3 | 5 | 8 | 8 |

7 Grounding and Bonding

The internal grounding terminal shall be used as the primary equipment ground.

The external terminal is only a supplemental bonding connection where local authorities permit or require such a connection.

8 Maintenance

|  WARNING | |
|--|--|
|  | <p>Danger from energised parts!</p> <ul style="list-style-type: none"> ▷ Risk of severe injuries. ▶ Before any maintenance work commences, disconnect the device from the power supply. ▶ Secure the device against unauthorised activation. |
|  WARNING | |
| <p>Risk due to unauthorised work performed on the device!</p> <ul style="list-style-type: none"> ▷ There is a risk of injury and damage to equipment. ▶ Assembly, installation, commissioning, operating and maintenance work must only be performed by personnel who is both authorized and suitably trained for this purpose. | |

8.1 Regular maintenance work

- Consult the relevant regulations to determine the type and extent of inspections.
- Plan the intervals so that any defects in the equipment which may be anticipated are promptly detected.

To check as part of the maintenance schedule:



- X Inspect device for visible damage.

8.2 Cleaning

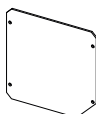

- X Clean with a cloth, brush, vacuum cleaner or similar items.

9 Accessories and Spare parts

Accessories and Spare Parts

| Designation | Figure | Description | Art. no. | Weight |
|----------------|---|--------------------------------|----------|--------|
| | | | | kg |
| Mounting plate |  11401E00 | for enclosure size 1 | 208862 | 0.120 |
| | | for enclosure size 2 | 143484 | 0.189 |
| | | for enclosure size 3 | 143485 | 0.364 |
| | | for enclosure size 4 | 143486 | 0.744 |
| | | for enclosure size 5 | 143487 | 1.070 |
| | | for enclosure size 6 | 143488 | 1.700 |
| O-Ring |  11402E00 | Silicone, for enclosure size 1 | 211270 | 0.006 |
| | | Silicone, for enclosure size 2 | 221717 | 0.008 |
| | | Silicone, for enclosure size 3 | 221718 | 0.010 |
| | | Silicone, for enclosure size 4 | 221719 | 0.012 |
| | | Silicone, for enclosure size 5 | 211271 | 0.020 |
| | | Silicone, for enclosure size 6 | 221720 | 0.026 |

Accessories and Spare Parts

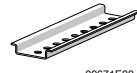
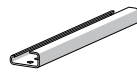
| Designation | Figure | Description | Art. no. | Weight |
|--------------------------|---|--|----------|--------|
| | | | | kg |
| Drain and breather valve |  15776E00 | with thread 3/8" | 107998 | 0.026 |
| | | with thread 1/2" | 107999 | 0.090 |
| Mounting rail |  14856E00 | TS15 L 80 mm for enclosure size 1 | 212425 | 0.013 |
| | | TS15 L 90 mm, diagonal for enclosure size 1 | 212338 | 0.010 |
| | | TS15 L 105 mm for enclosure size 2 | 143497 | 0.018 |
| | | TS15 L 133 mm for enclosure size 3 | 137902 | 0.020 |
| | | TS15 L 189 mm for enclosure size 4 | 137908 | 0.029 |
| | | TS15 L 218 mm for enclosure size 5 | 212427 | 0.030 |
| | | TS15 L 280 mm for enclosure size 6 | 166448 | 0.049 |
| |  09671E00 | TS35 L 80 mm for enclosure size 1 | 212424 | 0.027 |
| | | TS35 L 90 mm, diagonal for enclosure size 1 | 212339 | 0.025 |
| | | TS35 L 105 mm for enclosure size 2 | 143498 | 0.037 |
| | | TS35 L 133 mm for enclosure size 3 | 137970 | 0.040 |
| | | TS35 L 189 mm for enclosure size 4 | 137976 | 0.060 |
| | | TS35 L 218 mm for enclosure size 5 | 212426 | 0.033 |
| | | TS35 L 280 mm for enclosure size 6 | 166449 | 0.100 |
| |  15760E00 | G32 L 133 mm for enclosure size 3 | 137939 | 0.020 |
| | | G32 L 189 mm for enclosure size 4 | 137945 | 0.130 |
| | | G32 L 218 mm for enclosure size 5 | 212428 | 0.135 |
| | | G32 L 280 mm for enclosure size 6 | 166450 | 0.200 |

Accessories and Spare Parts

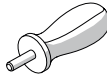
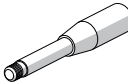
| Designation | Figure | Description | Art. no. | Weight |
|-------------------|---|---|----------|--------|
| | | | | kg |
| Grub screw |  05984E00 | M5x16-A2 with hexagon socket and pointed tip | 110216 | 0.001 |
| Key |  05986E00 | to open the enclosure cover for size 1, 2, 3, 4 2 wrenches are required. | 142059 | 0.060 |
| Adjustable wrench |  13135E00 | to open the enclosure cover for size 5, 6 2 wrenches are required. | 221927 | 0.214 |

 **WARNING**

Use of non-approved accessories and spare parts.

- ▷ The manufacturer's liability and warranty expire.
- ▶ Use only original accessories and original spare parts manufactured by R. STAHL.