

Elbows

Series ELF



Selection Table

Version	Nominal diameter	Type	Order number	Weight kg
Elbows, Series ELF, with 2 x female union  00677E00	NPT 1/2"	ELF1	108094	0.055
	NPT 3/4"	ELF2	108095	0.100
	NPT 1"	ELF3	108096	0.200
	NPT 1 1/2"	ELF5	108097	0.370
	NPT 2"	ELF6	108098	0.625
	NPT 2 1/2"	ELF7	108099	0.880
	NPT 3"	ELF8	108100	1.480

Explosion Protection

Explosion protection

Europe (ATEX)
Gas and dust

CESI 01 ATEX 104 U
 II 2 G Ex d IIC / Ex e II
 II 2 D Ex tD A21 IP66/67

Certifications and certificates

Certificates

ATEX, Belarus (operating licence)

Technical Data

Mechanical data

Material

aluminium alloy (copper-free)

Dimensional Drawings (All Dimensions in mm) - Subject to Alteration

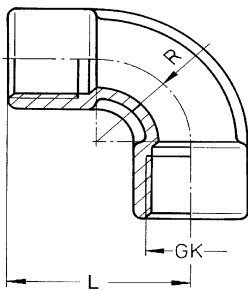

Type	Dimensions		
	GK	R [mm]	L [mm]
ELF1	NPT 1/2"	25	41
ELF2	NPT 3/4"	30	50
ELF3	NPT 1"	35	66
ELF5	NPT 1 1/2"	50	81
ELF6	NPT 2"	60	94
ELF7	NPT 2 1/2"	65	110
ELF8	NPT 3"	85	154

We reserve the right to make alterations to the technical data, dimensions, weights, designs and products available without notice. The illustrations cannot be considered binding.