



- For safe cable entry in Ex e and Ex i areas
- Can be used at temperatures of between -60 ... +75 °C, degree of protection IP68
- Available in Ex e and Ex i versions (Ex i version distinguished by its blue cap nut)
- Suitable for cable diameters from 1 ... 48 mm
- Versions with multi-seal inserts

WebCode **8161B**



R. STAHL's 8161/7 and 8161/8 series cable entries can be used to safely run cables into Ex e enclosures. They are suitable for cables between 1 to 48 mm in diameter. They are available for Ex e and Ex i circuits – the Ex i version can be distinguished by its blue cap nut. A stopping plug can be integrated to seal any cable entries that are not being used.

	IECEX / ATEX					
Zone	0	1	2	20	21	22
Installation in		•	•		•	•

Selection Table										
Product Description		Cable gland For low temperature								
Ambient temperature		-60 °C ... +75 °C								
Variant		Standard thread								
Ex version		Ex e								
Thread size	Clamping range	Width across flats	Width across corners	Thread length	Total length	Colour	Lot size	Product Type	Art. No.	Weight
M20	7 – 13 mm	24 mm	27 mm	10 mm	36 to 43 mm	Black	50	8161/7-M20-1307-LT	239204	13 g
M25	10 – 17 mm	29 mm	32 mm	10 mm	38 to 46 mm	Black	50	8161/7-M25-1710-LT	239205	19 g
M32	13 – 21 mm	36 mm	40 mm	12 mm	42 to 50 mm	Black	25	8161/7-M32-2113-LT	239206	32 g
M40	17 – 28 mm	46 mm	51 mm	12 mm	52 to 65 mm	Black	10	8161/7-M40-2817-LT	239207	68 g
M50	23 – 35 mm	55 mm	61 mm	14 mm	59 to 72 mm	Black	4	8161/7-M50-3523-LT	239208	107 g
M63	34 – 48 mm	68 mm	75 mm	15 mm	64 to 78 mm	Black	1	8161/7-M63-4834-LT	239209	155 g
Product Description		Cable gland For low temperature								
Ambient temperature		-60 °C ... +75 °C								
Variant		Standard thread								
Ex version		Ex i								
Thread size	Clamping range	Width across flats	Width across corners	Thread length	Total length	Colour	Lot size	Product Type	Art. No.	Weight
M20	7 – 13 mm	24 mm	27 mm	10 mm	36 to 43 mm	Blue	50	8161/8-M20-1307-LT	239212	13 g
M25	10 – 17 mm	29 mm	32 mm	10 mm	38 to 46 mm	Blue	50	8161/8-M25-1710-LT	239213	19 g
M32	13 – 21 mm	36 mm	40 mm	12 mm	42 to 50 mm	Blue	25	8161/8-M32-2113-LT	239214	32 g

Selection Table										
Product Description			Cable gland For low temperature							
Ambient temperature			-60 °C ... +75 °C							
Variant			Standard thread							
Ex version			Ex i							
Thread size	Clamping range	Width across flats	Width across corners	Thread length	Total length	Colour	Lot size	Product Type	Art. No.	Weight
M40	17 – 28 mm	46 mm	51 mm	12 mm	52 to 65 mm	Blue	10	8161/8-M40-2817-LT	239215	68 g
M50	23 – 35 mm	55 mm	61 mm	14 mm	59 to 72 mm	Blue	4	8161/8-M50-3523-LT	239216	107 g
M63	34 – 48 mm	68 mm	75 mm	15 mm	64 to 78 mm	Blue	1	8161/8-M63-4834-LT	239217	155 g
Product Description			Cable gland For low temperature							
Ambient temperature			-40 °C ... +75 °C							
Variant			Standard thread							
Ex version			Ex e							
Thread size	Clamping range	Width across flats	Width across corners	Thread length	Total length	Colour	Lot size	Product Type	Art. No.	Weight
M16	5 – 9 mm	20 mm	22 mm	9 mm	31 to 37 mm	Black	50	8161/7-M16-0905-LT	239203	9 g
Product Description			Cable gland For low temperature							
Ambient temperature			-40 °C ... +75 °C							
Variant			Standard thread							
Ex version			Ex i							
Thread size	Clamping range	Width across flats	Width across corners	Thread length	Total length	Colour	Lot size	Product Type	Art. No.	Weight
M16	5 – 9 mm	20 mm	22 mm	9 mm	31 to 37 mm	Blue	50	8161/8-M16-0905-LT	239211	9 g
Product Description			Cable gland with multiple sealing insert Black							
Number of cables			4							
Ambient temperature			-40 °C ... +75 °C							
Ex version			Ex e							
Thread size	Clamping range	Width across flats	Width across corners	Thread length	Total length	Colour	Lot size	Product Type	Art. No.	Weight
M25	3.2 – 3.5 mm	29 mm	32 mm	10 mm	38 to 46 mm	Black	50	8161/7-M25-9999-MFD-04035	265083	20 g
Product Description			Cable gland with multiple sealing insert Black							
Number of cables			4							
Ambient temperature			-40 °C ... +75 °C							
Ex version			Ex i							
Thread size	Clamping range	Width across flats	Width across corners	Thread length	Total length	Colour	Lot size	Product Type	Art. No.	Weight
M25	3.2 – 3.5 mm	29 mm	32 mm	10 mm	38 to 46 mm	Blue	50	8161/8-M25-9999-MFD-04035	265084	20 g
Product Description			Cable gland with multiple sealing insert Green							
Number of cables			4							
Ambient temperature			-40 °C ... +75 °C							
Ex version			Ex e							
Thread size	Clamping range	Width across flats	Width across corners	Thread length	Total length	Colour	Lot size	Product Type	Art. No.	Weight
M25	4.1 – 4.5 mm	29 mm	32 mm	10 mm	38 to 46 mm	Black	50	8161/7-M25-9999-MFD-04045	265085	20 g
Product Description			Cable gland with multiple sealing insert Green							
Number of cables			4							
Ambient temperature			-40 °C ... +75 °C							
Ex version			Ex i							
Thread size	Clamping range	Width across flats	Width across corners	Thread length	Total length	Colour	Lot size	Product Type	Art. No.	Weight
M25	4.1 – 4.5 mm	29 mm	32 mm	10 mm	38 to 46 mm	Blue	50	8161/8-M25-9999-MFD-04045	265086	20 g

Selection Table											
Product Description Number of cables Ambient temperature Ex version				Cable gland with multiple sealing insert Red 4 -40 °C ... +75 °C Ex e							
Thread size	Clamping range	Width across flats	Width across corners	Thread length	Total length	Colour	Lot size	Product Type	Art. No.	Weight	
M25	4.7 – 5.2 mm	29 mm	32 mm	10 mm	38 to 46 mm	Black	50	8161/7-M25-9999-MFD-04052	265087	20 g	
M32	4.5 – 5 mm	36 mm	40 mm	12 mm	42 to 50 mm	Black	25	8161/7-M32-9999-MFD-04050	265089	36 g	
Product Description Number of cables Ambient temperature Ex version				Cable gland with multiple sealing insert Red 4 -40 °C ... +75 °C Ex i							
Thread size	Clamping range	Width across flats	Width across corners	Thread length	Total length	Colour	Lot size	Product Type	Art. No.	Weight	
M25	4.7 – 5.2 mm	29 mm	32 mm	10 mm	38 to 46 mm	Blue	50	8161/8-M25-9999-MFD-04052	265088	20 g	
M32	4.5 – 5 mm	36 mm	40 mm	12 mm	42 to 50 mm	Blue	25	8161/8-M32-9999-MFD-04050	265090	36 g	
Product Description Number of cables Ambient temperature Ex version				Cable gland with multiple sealing insert White 4 -40 °C ... +75 °C Ex e							
Thread size	Clamping range	Width across flats	Width across corners	Thread length	Total length	Colour	Lot size	Product Type	Art. No.	Weight	
M25	3.6 – 4 mm	29 mm	32 mm	10 mm	38 to 46 mm	Black	50	8161/7-M25-9999-MFD-04040	261983	20 g	
M25	5.4 – 6 mm	29 mm	32 mm	10 mm	38 to 46 mm	Black	50	8161/7-M25-9999-MFD-04060	261981	20 g	
M32	6.3 – 7 mm	36 mm	40 mm	12 mm	42 to 50 mm	Black	25	8161/7-M32-9999-MFD-04070	265091	36 g	
Product Description Number of cables Ambient temperature Ex version				Cable gland with multiple sealing insert White 4 -40 °C ... +75 °C Ex i							
Thread size	Clamping range	Width across flats	Width across corners	Thread length	Total length	Colour	Lot size	Product Type	Art. No.	Weight	
M25	3.6 – 4 mm	29 mm	32 mm	10 mm	38 to 46 mm	Blue	50	8161/8-M25-9999-MFD-04040	261984	20 g	
M25	5.4 – 6 mm	29 mm	32 mm	10 mm	38 to 46 mm	Blue	50	8161/8-M25-9999-MFD-04060	261982	20 g	
M32	6.3 – 7 mm	36 mm	40 mm	12 mm	42 to 50 mm	Blue	25	8161/8-M32-9999-MFD-04070	265092	36 g	
Product Description Ambient temperature Variant Ex version				Cable gland Without reduction sealing insert -40 °C ... +75 °C Standard thread Ex e							
Thread size	Clamping range	Width across flats	Width across corners	Thread length	Total length	Colour	Lot size	Product Type	Art. No.	Weight	
M16	5 – 9 mm	20 mm	22 mm	9 mm	31 to 37 mm	Black	50	8161/7-M16-0905	239171	9 g	
M20	7 – 13 mm	24 mm	27 mm	10 mm	36 to 43 mm	Black	50	8161/7-M20-1307	239172	13 g	
M25	10 – 17 mm	29 mm	32 mm	10 mm	38 to 46 mm	Black	50	8161/7-M25-1710	239173	19 g	

Selection Table										
Product Description			Cable gland Without reduction sealing insert							
Ambient temperature			-40 °C ... +75 °C							
Variant			Standard thread							
Ex version			Ex e							
Thread size	Clamping range	Width across flats	Width across corners	Thread length	Total length	Colour	Lot size	Product Type	Art. No.	Weight
M32	13 – 21 mm	36 mm	40 mm	12 mm	42 to 50 mm	Black	25	8161/7-M32-2113	239174	32 g
M40	17 – 28 mm	46 mm	51 mm	12 mm	52 to 65 mm	Black	10	8161/7-M40-2817	239175	68 g
M50	23 – 35 mm	55 mm	61 mm	14 mm	59 to 72 mm	Black	4	8161/7-M50-3523	239176	107 g
M63	34 – 48 mm	68 mm	75 mm	15 mm	64 to 78 mm	Black	1	8161/7-M63-4834	239177	155 g
Product Description			Cable gland Without reduction sealing insert							
Ambient temperature			-40 °C ... +75 °C							
Variant			Standard thread							
Ex version			Ex i							
Thread size	Clamping range	Width across flats	Width across corners	Thread length	Total length	Colour	Lot size	Product Type	Art. No.	Weight
M16	5 – 9 mm	20 mm	22 mm	9 mm	31 to 37 mm	Blue	50	8161/8-M16-0905	239179	9 g
M20	7 – 13 mm	24 mm	27 mm	10 mm	36 to 43 mm	Blue	50	8161/8-M20-1307	239180	13 g
M25	10 – 17 mm	29 mm	32 mm	10 mm	38 to 46 mm	Blue	50	8161/8-M25-1710	239181	19 g
M32	13 – 21 mm	36 mm	40 mm	12 mm	42 to 50 mm	Blue	25	8161/8-M32-2113	239182	32 g
M40	17 – 28 mm	46 mm	51 mm	12 mm	52 to 65 mm	Blue	10	8161/8-M40-2817	239183	68 g
M50	23 – 35 mm	55 mm	61 mm	14 mm	59 to 72 mm	Blue	4	8161/8-M50-3523	239184	107 g
M63	34 – 48 mm	68 mm	75 mm	15 mm	64 to 78 mm	Blue	1	8161/8-M63-4834	239185	155 g
Product Description			Cable gland Without reduction sealing insert							
Ambient temperature			15 °C ... +65 °C							
Variant			Standard thread							
Ex version			Ex e							
Thread size	Clamping range	Width across flats	Width across corners	Thread length	Total length	Colour	Lot size	Product Type	Art. No.	Weight
M12	3 – 6 mm	16 mm	18 mm	9 mm	29 to 34 mm	Black	50	8161/7-M12-0603	239170	7 g
Product Description			Cable gland Without reduction sealing insert							
Ambient temperature			15 °C ... +65 °C							
Variant			Standard thread							
Ex version			Ex i							
Thread size	Clamping range	Width across flats	Width across corners	Thread length	Total length	Colour	Lot size	Product Type	Art. No.	Weight
M12	3 – 6 mm	16 mm	18 mm	9 mm	29 to 34 mm	Blue	50	8161/8-M12-0603	239178	7 g
Product Description			Cable gland With reduction sealing insert							
Ambient temperature			-40 °C ... +75 °C							
Variant			Long thread							
Ex version			Ex e							
Thread size	Clamping range	Width across flats	Width across corners	Thread length	Total length	Colour	Lot size	Product Type	Art. No.	Weight
M16	2 – 9 mm	20 mm	22 mm	15 mm	37 to 43 mm	Black	50	8161/7-M16-0902-L	239187	9 g
M20	4 – 13 mm	24 mm	27 mm	15 mm	41 to 48 mm	Black	50	8161/7-M20-1304-L	239188	13 g
M25	7 – 17 mm	29 mm	32 mm	15 mm	43 to 51 mm	Black	50	8161/7-M25-1707-L	239189	19 g

Selection Table										
Product Description			Cable gland With reduction sealing insert							
Ambient temperature			-40 °C ... +75 °C							
Variant			Long thread							
Ex version			Ex e							
Thread size	Clamping range	Width across flats	Width across corners	Thread length	Total length	Colour	Lot size	Product Type	Art. No.	Weight
M32	9 – 21 mm	36 mm	40 mm	15 mm	45 to 53 mm	Black	25	8161/7-M32-2109-L	239190	32 g
M40	12 – 28 mm	46 mm	51 mm	18 mm	58 to 71 mm	Black	10	8161/7-M40-2812-L	239191	68 g
M50	16 – 35 mm	55 mm	61 mm	18 mm	63 to 76 mm	Black	4	8161/7-M50-3516-L	239192	107 g
M63	28 – 48 mm	68 mm	75 mm	18 mm	67 to 81 mm	Black	1	8161/7-M63-4828-L	239193	155 g
Product Description			Cable gland With reduction sealing insert							
Ambient temperature			-40 °C ... +75 °C							
Variant			Long thread							
Ex version			Ex i							
Thread size	Clamping range	Width across flats	Width across corners	Thread length	Total length	Colour	Lot size	Product Type	Art. No.	Weight
M16	2 – 9 mm	20 mm	22 mm	15 mm	37 to 43 mm	Blue	50	8161/8-M16-0902-L	239195	9 g
M20	4 – 13 mm	24 mm	27 mm	15 mm	41 to 48 mm	Blue	50	8161/8-M20-1304-L	239196	13 g
M25	7 – 17 mm	29 mm	32 mm	15 mm	43 to 51 mm	Blue	50	8161/8-M25-1707-L	239197	19 g
M32	9 – 21 mm	36 mm	40 mm	15 mm	45 to 53 mm	Blue	25	8161/8-M32-2109-L	239198	32 g
M40	12 – 28 mm	46 mm	51 mm	18 mm	58 to 71 mm	Blue	10	8161/8-M40-2812-L	239199	68 g
M63	28 – 48 mm	68 mm	75 mm	18 mm	67 to 81 mm	Blue	1	8161/8-M63-4828-L	239201	155 g
Product Description			Cable gland With reduction sealing insert							
Ambient temperature			-40 °C ... +75 °C							
Variant			Standard thread							
Ex version			Ex e							
Thread size	Clamping range	Width across flats	Width across corners	Thread length	Total length	Colour	Lot size	Product Type	Art. No.	Weight
M16	2 – 9 mm	20 mm	22 mm	9 mm	31 to 37 mm	Black	50	8161/7-M16-0902	239155	9 g
M20	4 – 13 mm	24 mm	27 mm	10 mm	36 to 43 mm	Black	50	8161/7-M20-1304	239156	13 g
M25	7 – 17 mm	29 mm	32 mm	10 mm	38 to 46 mm	Black	50	8161/7-M25-1707	239157	19 g
M32	9 – 21 mm	36 mm	40 mm	12 mm	42 to 50 mm	Black	25	8161/7-M32-2109	239158	32 g
M40	12 – 28 mm	46 mm	51 mm	12 mm	52 to 65 mm	Black	10	8161/7-M40-2812	239159	68 g
M50	16 – 35 mm	55 mm	61 mm	14 mm	59 to 72 mm	Black	4	8161/7-M50-3516	239160	107 g
M63	28 – 48 mm	68 mm	75 mm	15 mm	64 to 78 mm	Black	1	8161/7-M63-4828	239161	155 g
Product Description			Cable gland With reduction sealing insert							
Ambient temperature			-40 °C ... +75 °C							
Variant			Standard thread							
Ex version			Ex i							
Thread size	Clamping range	Width across flats	Width across corners	Thread length	Total length	Colour	Lot size	Product Type	Art. No.	Weight
M16	2 – 9 mm	20 mm	22 mm	9 mm	31 to 37 mm	Blue	50	8161/8-M16-0902	239163	9 g
M20	4 – 13 mm	24 mm	27 mm	10 mm	36 to 43 mm	Blue	50	8161/8-M20-1304	239164	13 g

Selection Table										
Product Description			Cable gland With reduction sealing insert							
Ambient temperature			-40 °C ... +75 °C							
Variant			Standard thread							
Ex version			Ex i							
Thread size	Clamping range	Width across flats	Width across corners	Thread length	Total length	Colour	Lot size	Product Type	Art. No.	Weight
M25	7 – 17 mm	29 mm	32 mm	10 mm	38 to 46 mm	Blue	50	8161/8-M25-1707	239165	19 g
M32	9 – 21 mm	36 mm	40 mm	12 mm	42 to 50 mm	Blue	25	8161/8-M32-2109	239166	32 g
M40	12 – 28 mm	46 mm	51 mm	12 mm	52 to 65 mm	Blue	10	8161/8-M40-2812	239167	68 g
M50	16 – 35 mm	55 mm	61 mm	14 mm	59 to 72 mm	Blue	4	8161/8-M50-3516	239168	107 g
M63	28 – 48 mm	68 mm	75 mm	15 mm	64 to 78 mm	Blue	1	8161/8-M63-4828	239169	155 g
Product Description			Cable gland With reduction sealing insert							
Ambient temperature			15 °C ... +65 °C							
Variant			Long thread							
Ex version			Ex e							
Thread size	Clamping range	Width across flats	Width across corners	Thread length	Total length	Colour	Lot size	Product Type	Art. No.	Weight
M12	1 – 6 mm	16 mm	18 mm	15 mm	35 to 40 mm	Black	50	8161/7-M12-0601-L	239186	7 g
Product Description			Cable gland With reduction sealing insert							
Ambient temperature			15 °C ... +65 °C							
Variant			Long thread							
Ex version			Ex i							
Thread size	Clamping range	Width across flats	Width across corners	Thread length	Total length	Colour	Lot size	Product Type	Art. No.	Weight
M12	1 – 6 mm	16 mm	18 mm	15 mm	35 to 40 mm	Blue	50	8161/8-M12-0601-L	239194	7 g
Product Description			Cable gland With reduction sealing insert							
Ambient temperature			15 °C ... +65 °C							
Variant			Standard thread							
Ex version			Ex e							
Thread size	Clamping range	Width across flats	Width across corners	Thread length	Total length	Colour	Lot size	Product Type	Art. No.	Weight
M12	1 – 6 mm	16 mm	18 mm	9 mm	29 to 34 mm	Black	50	8161/7-M12-0601	239154	7 g
Product Description			Cable gland With reduction sealing insert							
Ambient temperature			15 °C ... +65 °C							
Variant			Standard thread							
Ex version			Ex i							
Thread size	Clamping range	Width across flats	Width across corners	Thread length	Total length	Colour	Lot size	Product Type	Art. No.	Weight
M12	1 – 6 mm	16 mm	18 mm	9 mm	29 to 34 mm	Blue	50	8161/8-M12-0601	239162	7 g

Lot size: Purchase order quantity in [pieces], the delivery quantity is automatically rounded to the lot size.

Technical Data		
Variant	8161/-M.-....	8161/-M.-....-LT
Explosion Protection		
IECEX gas explosion protection	Ex eb IIC Gb	Ex eb IIC Gb
IECEX dust explosion protection	Ex tb IIIC Db	Ex tb IIIC Db
ATEX gas explosion protection	Ⓜ II 2 G Ex eb IIC Gb	Ⓜ II 2 G Ex eb IIC Gb
ATEX dust explosion protection	Ⓜ II 2 D Ex tb IIIC Db	Ⓜ II 2 D Ex tb IIIC Db
Certificates	ATEX (PTB), IECEX (PTB), Korea (KGS)	ATEX (PTB), IECEX (PTB), Korea (KGS)

Technical Data		
Variant	8161/-M.-.....	8161/-M.-.....-LT
Mechanical Data		
Material	Polyamide, Glass fibre reinforced	Polyamide, Glass fibre reinforced
Material	Polyamide	Polyamide
Degree of protection (IP)	IP66	IP66
Degree of protection note	IP68 at 5 bar 30 min. (IP protection according to IEC/EN 60529)	IP68 at 5 bar 30 min. (IP protection according to IEC/EN 60529)
Sealing material	EPDM profile seal	SI profile seal
Silicone-free	Yes	No
Self-extinguishing	Yes	Yes
Flame-retardant	Yes	Yes
Halogen-free	Yes	Yes
Surface resistance	$\leq 10^{13} \Omega$	$\leq 10^{13} \Omega$

Accessories				
Figure	Description		Art. No.	Weight
Locknut, brass nickel-plated (-60 ... +75 °C) To fasten the cable glands in through holes				
	Material: Nickel-plated brass Thread size: M12	Lot size: 100	241518	220 g
	Material: Nickel-plated brass Thread size: M16	Lot size: 100	241519	290 g
	Material: Nickel-plated brass Thread size: M20	Lot size: 100	241520	480 g
	Material: Nickel-plated brass Thread size: M25	Lot size: 100	241561	720 g
	Material: Nickel-plated brass Thread size: M32	Lot size: 50	241562	545 g
	Material: Nickel-plated brass Thread size: M40	Lot size: 50	241563	1.03 kg
	Material: Nickel-plated brass Thread size: M50	Lot size: 25	241564	680 g
	Material: Nickel-plated brass Thread size: M63	Lot size: 10	241565	499 g
Locknut, plastic (-40 ... +75 °C) To fasten the cable glands in through holes				
	Material: Polyamide Thread size: M12	Lot size: 100	239460	1 g
	Material: Polyamide Thread size: M16	Lot size: 100	239461	2 g
	Material: Polyamide Thread size: M20	Lot size: 100	239462	2 g
	Material: Polyamide Thread size: M25	Lot size: 100	239463	3 g
	Material: Polyamide Thread size: M40	Lot size: 50	239465	7 g
	Material: Polyamide Thread size: M50	Lot size: 25	239466	12 g
	Material: Polyamide Thread size: M63	Lot size: 10	239467	18 g

Accessories

Figure	Description	Art. No.	Weight
Reduction sealing insert (standard), EPDM (-40 ... +75 °C)			
For cable glands			
	Connection thread: M12 x 1.5 Clamping range: 1 – 3 mm	Lot size: 50	239444 1 g
	Connection thread: M16 x 1.5 Clamping range: 2 – 6 mm	Lot size: 50	239445 1 g
	Connection thread: M20 x 1.5 Clamping range: 4 – 8 mm	Lot size: 50	239446 1 g
	Connection thread: M25 x 1.5 Clamping range: 7 – 12 mm	Lot size: 25	239447 3 g
	Connection thread: M32 x 1.5 Clamping range: 9 – 14 mm	Lot size: 25	239448 3 g
	Connection thread: M40 x 1.5 Clamping range: 12 – 20 mm	Lot size: 10	239449 7 g
	Connection thread: M50 x 1.5 Clamping range: 16 – 25 mm	Lot size: 10	239450 12 g
	Connection thread: M63 x 1.5 Clamping range: 28 – 38 mm	Lot size: 10	239451 19 g
Reduction sealing insert, silicone (-60 ... +75 °C)			
For low temperature			
	Connection thread: M16 x 1.5 Clamping range: 2 – 6 mm	Lot size: 50	239453 1 g
	Connection thread: M20 x 1.5 Clamping range: 4 – 8 mm	Lot size: 50	239454 1 g
	Connection thread: M25 x 1.5 Clamping range: 7 – 12 mm	Lot size: 25	239455 2 g
	Connection thread: M32 x 1.5 Clamping range: 9 – 14 mm	Lot size: 25	239456 3 g
	Connection thread: M40 x 1.5 Clamping range: 12 – 20 mm	Lot size: 10	239457 8 g
	Connection thread: M50 x 1.5 Clamping range: 16 – 25 mm	Lot size: 10	239458 15 g
Special key			
	Thread size: M16	Packaging unit: 1	114207 120 g
	Thread size: M20	Packaging unit: 1	114208 132 g
	Thread size: M25	Packaging unit: 1	114205 163 g
	Thread size: M32	Packaging unit: 1	114209 237 g
	Thread size: M40	Packaging unit: 1	114210 274 g
Plug (-60 ... +75 °C; depending on cable gland that has been used)			
For closing unused cable glands			
Material: Polyamide			
	Diameter: 3 mm	Lot size: 50	240044 1 g
	Diameter: 6 mm	Lot size: 50	240046 1 g
	Diameter: 8 mm	Lot size: 50	240048 1 g
	Diameter: 12 mm	Lot size: 50	240049 2 g
	Diameter: 17 mm	Lot size: 50	240056 3 g
	Diameter: 14 mm	Lot size: 50	240050 3 g
	Diameter: 20 mm	Lot size: 25	240057 4 g
	Diameter: 28 mm	Lot size: 25	240059 9 g
	Diameter: 25 mm	Lot size: 25	240058 7 g
	Diameter: 35 mm	Lot size: 10	240060 10 g
	Diameter: 48 mm	Lot size: 10	240062 28 g

Spare Parts				
Figure	Description		Art. No.	Weight
Flat gasket (standard), EPDM (-40 ... +75 °C)				
Replacement seals for cable glands				
	For cable glands 8161/-M12-06... Connection thread: M12 x 1.5	Lot size: 100	240245	1 g
	For cable glands 8161/-M12-06... Connection thread: M12 x 1.5	Lot size: 50	240244	1 g
	For cable glands 8161/-M16-09.. Connection thread: M16	Lot size: 100	222370	1 g
	For cable glands 8161/-M16-09... Connection thread: M16	Lot size: 50	222363	1 g
	For cable glands 8161/-M20-13 Connection thread: M20	Lot size: 100	222371	1 g
	For cable glands 8161/-M20-13 Connection thread: M20	Lot size: 50	222364	1 g
	For cable glands 8161/-M25-17 Connection thread: M25	Lot size: 100	222372	1 g
	For cable glands 8161/-M25-17 Connection thread: M25	Lot size: 50	222365	1 g
	For cable glands 8161/-M32-21 Connection thread: M32	Lot size: 100	222373	1 g
	For cable glands 8161/-M32-21 Connection thread: M32	Lot size: 50	222366	1 g
	For cable glands 8161/-M40-28 Connection thread: M40	Lot size: 100	222374	2 g
	For cable glands 8161/-M40-28 Connection thread: M40	Lot size: 50	222367	2 g
	For cable glands 8161/-M50-35 Connection thread: M50	Lot size: 100	222375	2 g
	For cable glands 8161/-M50-35 Connection thread: M50	Lot size: 50	222368	2 g
	For cable glands 8161/-M63-48 Connection thread: M63	Lot size: 100	222376	2 g
For cable glands 8161/-M63-48 Connection thread: M63	Lot size: 50	222369	2 g	
Flat gasket silicone (-60 ... +75 °C)				
Replacement seals for low temperature				
	For cable glands 8161/-M16-09.. Connection thread: M16	Lot size: 100	240248	1 g
	For cable glands 8161/-M20-13 Connection thread: M20	Lot size: 100	240249	1 g
	For cable glands 8161/-M25-17 Connection thread: M25	Lot size: 100	240250	1 g
	For cable glands 8161/-M32-21 Connection thread: M32	Lot size: 100	240251	1 g
	For cable glands 8161/-M40-28 Connection thread: M40	Lot size: 100	240252	2 g
	For cable glands 8161/-M50-35 Connection thread: M50	Lot size: 100	240253	2 g
	For cable glands 8161/-M63-48 Connection thread: M63	Lot size: 100	240254	2 g

Lot size: Purchase order quantity in [pieces], the delivery quantity is automatically rounded to the lot size.

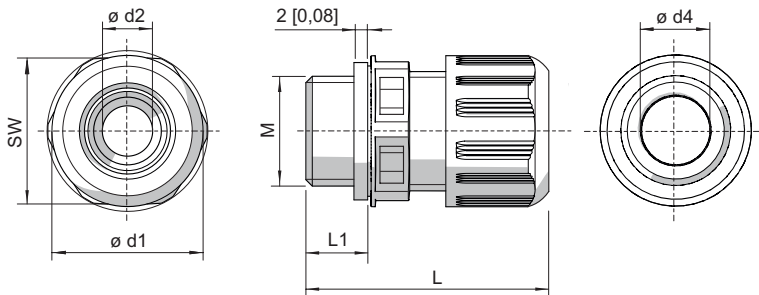

M = Thread size SW = Width across flats
 L1 = Thread length L = Total length

Cable glands without bend protection

Thread size	Width across flats	Total length	Total length (with long thread)	Thread length	Thread length (long thread)	Clamping range	Clamping range + reduction sealing insert	Dimension d1	Dimension d2	Dimension d4
M12	16.00 mm	29 to 34 mm	35 to 40 mm	9 mm	15 mm	3 - 6 mm	1 - 6 mm	18 mm	7.3 mm	6.3 mm
M16	20.00 mm	31 to 37 mm	37 to 43 mm	9 mm	15 mm	5 - 9 mm	2 - 9 mm	22 mm	10.3 mm	9.3 mm
M20	24.00 mm	36 to 43 mm	41 to 48 mm	10 mm	15 mm	7 - 13 mm	4 - 13 mm	27 mm	13.3 mm	13.3 mm
M25	29.00 mm	38 to 46 mm	43 to 51 mm	10 mm	15 mm	10 - 17 mm	7 - 17 mm	32 mm	17.3 mm	17.3 mm
M32	36.00 mm	42 to 50 mm	45 to 53 mm	12 mm	15 mm	13 - 21 mm	9 - 21 mm	40 mm	21.3 mm	21.3 mm
M40	46.00 mm	52 to 65 mm	58 to 71 mm	12 mm	18 mm	17 - 28 mm	12 - 28 mm	51 mm	28.3 mm	30 mm
M50	55.00 mm	59 to 72 mm	63 to 76 mm	14 mm	18 mm	23 - 35 mm	16 - 35 mm	61 mm	35.3 mm	40 mm
M63	68.00 mm	64 to 78 mm	67 to 81 mm	15 mm	18 mm	34 - 48 mm	28 - 48 mm	75 mm	48.3 mm	53 mm