

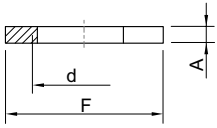

WebCode ACC1B

Selection Table						
Construction type WebCode Material incl. surface coating		Hexagon nut ACC1B Nickel-plated brass				
Thread size	Width across flats	Height	Lot size	Art. No.	Weight	
M12	15 mm	3 mm	100	241518	220 g	
M16	19 mm	3 mm	100	241519	290 g	
M20	24 mm	3 mm	100	241520	480 g	
M25	29 mm	3.5 mm	100	241561	720 g	
M32	36 mm	4 mm	50	241562	545 g	
M40	46 mm	4.5 mm	50	241563	1.03 kg	
M50	55 mm	5 mm	25	241564	680 g	
M63	70 mm	5.5 mm	10	241565	499 g	
NPT1/2"	27 mm	4.8 mm	100	253047	1.16 kg	
NPT1-1/2"	60 mm	5 mm	50	253051	1.64 kg	
NPT1-1/4"	50 mm	4.8 mm	50	253050	1.5 kg	
NPT1"	41 mm	4.8 mm	100	253049	1.6 kg	
NPT2-1/2"	84 mm	10 mm	10	253053	1.5 kg	
NPT2"	75 mm	5 mm	25	253052	1.38 kg	
NPT3/4"	33 mm	4.8 mm	100	253048	1.25 kg	
NPT3"	100 mm	10 mm	10	253054	3.77 kg	
Construction type WebCode Material incl. surface coating		Hexagon nut ACC1B Polyamide				
Thread size	Width across flats	Height	Lot size	Art. No.	Weight	
M12	SW18	5 mm	100	239460	1 g	
M16	SW22	5 mm	100	239461	2 g	
M20	SW27	5 mm	100	239462	2 g	
M25	SW32	6 mm	100	239463	3 g	
M40	SW50	7 mm	50	239465	7 g	
M50	SW60	7 mm	25	239466	12 g	
M63	SW75	7 mm	10	239467	18 g	

Lot size: Purchase order quantity in [pieces], the delivery quantity is automatically rounded to the lot size.



F = Width across flats d = Thread size A = Height