



- Ex d and Ex e metal reducers
- Large selection of thread types and sizes
- Operating temperature range: -60 °C ... +200 °C
- Worldwide certification, IECEx, ATEX, UL and cCSAus

E10

MY R. STAHL 737DA



The metal Ex-d reducers from the 737 series enable adaptation of the thread sizes and types. There is a wide selection of different versions available. They have worldwide certification according to IECEx, ATEX, UL and cCSAus.

	IECEx / ATEX					
Zone	0	1	2	20	21	22
Installation in		•	•	•	•	•

Selection Table					
Material	Nickel-plated brass				
External thread	Internal thread	Width across flats	Art. No.	Weight	
M20	M16	24 mm	253003	53 g	
M25	M20	30 mm	253004	100 g	
	NPT1/2	30 mm	230070	49 g	
M32	M20	37.6 mm	253005	98 g	
	M25	37.6 mm	253006	100 g	
	NPT3/4	37.6 mm	230101	72 g	
M40	M20	46 mm	253007	1 kg	
	M25	46 mm	253008	200 g	
	M32	46 mm	252970	265 g	
	NPT1	46 mm	230102	122 g	
M50	M32	55 mm	252971	175 g	
	M40	55 mm	252972	176 g	
	NPT1-1/4	55 mm	252973	150 g	
M63	M40	70 mm	252974	250 g	
	M50	70 mm	252975	130 g	
	NPT1-1/2	70 mm	252976	300 g	
M75	M63	84 mm	252977	203 g	
	NPT2	80 mm	252978	445 g	

Selection Table				
Material: Nickel-plated brass				
External thread	Internal thread	Width across flats	Art. No.	Weight
NPT1	M20	41 mm	252989	209 g
	M25	41 mm	252990	160 g
	NPT1/2	41 mm	253010	100 g
	NPT3/4	41 mm	253011	100 g
NPT1-1/2	M32	55 mm	252991	100 g
	NPT1	55 mm	253013	100 g
NPT1-1/4	NPT1	50 mm	253012	200 g
NPT3/4	M20	31.5 mm	252988	45 g
	NPT1/2	31.5 mm	253009	50 g
Material: Stainless steel				
External thread	Internal thread	Width across flats	Art. No.	Weight
M20	M16	24 mm	252979	1.9 kg
M25	M20	30 mm	252980	75 g
	NPT1/2	30 mm	230103	1 kg
M32	M25	37.6 mm	252981	100 g
	NPT3/4	37.6 mm	230104	100 g
M40	M32	46 mm	252982	120 g
	NPT1	46 mm	230105	200 g
M50	M32	55 mm	252983	120 g
	M40	55 mm	252984	100 g
	NPT1-1/4	55 mm	252985	200 g
M63	NPT1-1/2	70 mm	252986	300 g
M75	NPT2	80 mm	252987	300 g

Technical Data	
Explosion Protection	
IECEx gas explosion protection	Ex eb IIC Gb
IECEx gas explosion protection 2	Ex db IIC Gb
IECEx dust explosion protection	Ex ta IIIC Da
IECEx firedamp protection	Ex db I Mb
IECEx firedamp protection 2	Ex eb I Mb
ATEX gas explosion protection	Ⓔ II 2 G Ex eb IIC Gb
ATEX gas explosion protection 2	Ⓔ II 2 G Ex db IIC Gb
ATEX dust explosion protection	Ⓔ II 1 D Ex ta IIIC Da
ATEX firedamp protection	Ⓔ I M2 Ex db I Mb
ATEX firedamp protection 2	Ⓔ I M2 Ex eb I Mb
Notes	The product certification and certificates can be downloaded from the manufacturer's homepage (www.cmp-products.com)
Ambient Conditions	
Ambient temperature	-60 °C ... +200 °C
Mechanical Data	
Degree of protection (IP)	IP66
Degree of protection note	IP67 and IP68 mounting in accordance with the specifications of the manufacturer, CMP. The specified degrees of protection are only fulfilled if CMP installation accessories are used.
Silicone-free	Yes

Dimensional Drawings (All Dimensions in mm [inches]) – Subject to Alterations

E10

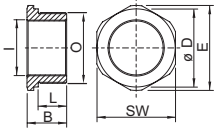

O = External thread I = Internal thread
SW = Width across flats E = Width across corners
B = Length L = Thread length