



- Operating temperature range: -40 °C to +70 °C
- Large inner connection chamber
- High-quality metal Ex e enclosure with outer PE connection
- Degree of protection IP66/67
- Five different contact versions
- Ten different actuator versions

E4

WebCode 8074D



Metal position switch; switch dimensions meet the requirements of DIN EN 50041. It is designed to detect the position of moving components. Certified versions fulfil the requirements for safety switches as set out in EN 13849-1 and have positive-opening contacts in accordance with EN 60947-5-1.

	IECEX / ATEX					
Zone	0	1	2	20	21	22
Installation in		•	•		•	•

Selection Table						
Actuator		Adjustable rotary lever				
Figure	Contacts	Switching function	Positive opening operation	Product Type	Art. No.	Weight
	1 NC + 1 NO	Slow-action contact	No	8074/2-1-DS-40	257189	386 g
		Slow-action contact, Overlapping	No	8074/2-5-DS-40	257218	386 g
	2 NC	Slow-action contact	No	8074/2-3-DS-40	257209	386 g
Actuator		Long rotary lever				
Figure	Contacts	Switching function	Positive opening operation	Product Type	Art. No.	Weight
	1 NC + 1 NO	Slow-action contact	Yes	8074/2-1-DL-40	257188	422 g
		Slow-action contact, Overlapping	Yes	8074/2-5-DL-40	257217	422 g
	2 NC	Slow-action contact	Yes	8074/2-3-DL-40	257208	422 g
Actuator		Misalignment switch				
Figure	Contacts	Switching function	Positive opening operation	Product Type	Art. No.	Weight
	1 NC + 1 NO	Slow-action contact	No	8074/2-1-SR-40	257201	486 g
Actuator		Parallel roller lever				
Figure	Contacts	Switching function	Positive opening operation	Product Type	Art. No.	Weight
	1 NC + 1 NO	Slow-action contact	Yes	8074/2-1-WPH-40	278572	-
		Slow-action contact	Yes	8074/2-2-WPH-40	278575	-
	2 NC	Slow-action contact	Yes	8074/2-3-WPH-40	278573	-

Selection Table						
Actuator		Plunger				
Figure	Contacts	Switching function	Positive opening operation	Product Type	Art. No.	Weight
	1 NC + 1 NO	Slow-action contact	Yes	8074/2-1-W-40	257197	298 g
		Slow-action contact, Overlapping	Yes	8074/2-5-W-40	257212	298 g
	2 NC	Slow-action contact	Yes	8074/2-3-W-40	257203	298 g
Actuator		Rod lever				
Figure	Contacts	Switching function	Positive opening operation	Product Type	Art. No.	Weight
	1 NC + 1 NO	Slow-action contact	No	8074/2-1-DD-40	257190	340 g
		Slow-action contact, Overlapping	No	8074/2-5-DD-40	257219	340 g
	2 NC	Slow-action contact	No	8074/2-3-DD-40	257210	340 g
Actuator		Roller lever				
Figure	Contacts	Switching function	Positive opening operation	Product Type	Art. No.	Weight
	1 NC + 1 NO	Slow-action contact	Yes	8074/2-1-WH-40	278457	-
		Slow-action contact	Yes	8074/2-2-WH-40	278571	-
		Slow-action contact	Yes	8074/2-5-WH-40	278459	-
	2 NC	Slow-action contact	Yes	8074/2-3-WH-40	278458	-
Actuator		Roller plunger				
Figure	Contacts	Switching function	Positive opening operation	Product Type	Art. No.	Weight
	1 NC + 1 NO	Slow-action contact	Yes	8074/2-1-R-40	257184	299 g
		Slow-action contact, Overlapping	Yes	8074/2-5-R-40	257213	299 g
	2 NC	Slow-action contact	Yes	8074/2-3-R-40	257204	299 g
Actuator		Rotary lever				
Figure	Contacts	Switching function	Positive opening operation	Product Type	Art. No.	Weight
	1 NC + 1 NO	Slow-action contact	Yes	8074/2-1-D-40	257187	360 g
		Slow-action contact, Overlapping	Yes	8074/2-5-D-40	257216	360 g
	2 NC	Slow-action contact	Yes	8074/2-3-D-40	257207	360 g
Actuator		Safety switch				
Figure	Contacts	Switching function	Positive opening operation	Product Type	Art. No.	Weight
	1 NC + 1 NO	Slow-action contact	Yes	8074/2-1-AZ-20	257202	340 g
	2 NC	Slow-action contact	No	8074/2-3-AZ-20	257211	340 g

The actuators enclosed are not mounted.  
Actuators without positive opening are not suitable for safety circuits!

Safety switch, separate actuator made of metal (please order separately; see spare parts and accessories)



Technical Data		
Variant	8074/2-1-...	8074/2-1-AZ-20
Explosion Protection		
IECEx gas explosion protection	Ex db eb IIC T6 / T5 Gb	Ex db eb IIC T6 / T5 Gb
IECEx dust explosion protection	Ex tb IIIC T80 °C / T95 °C Db	Ex tb IIIC T80 °C / T95 °C Db
ATEX gas explosion protection	Ⓔ II 2 G Ex db eb IIC T6 / T5 Gb	Ⓔ II 2 G Ex db eb IIC T6 / T5 Gb
ATEX dust explosion protection	Ⓔ II 2 D Ex tb IIIC T80 °C / T95 °C Db	Ⓔ II 2 D Ex tb IIIC T80 °C / T95 °C Db
Certificates	ATEX (BVS), China (CQST), IECEx (BVS)	ATEX (BVS), China (CQST), IECEx (BVS)

Technical Data		
Variant	8074/2-1-.-.	8074/2-1-AZ-20
Explosion Protection		
Notes	Product label may vary. Series devices have certification according to ATEX and IECEx.	
Electrical Data		
Rated operational voltage DC	125 V	230 V
AC operating voltage (equal potential)	500 V	250 V
AC operating voltage (unequal potential)	250 V	250 V
Rated operational current	4.4 A 6.6 A	0.25 A 6 A
Rated operational current note	4.4 A at T6 6.6 A at T5	0.25 A at 230 V DC 6 A at 250 V AC
Electrical service life	Max. 10 <sup>6</sup> operating cycles	Max. 10 <sup>6</sup> operating cycles
Mechanical service life	Max. 10 <sup>6</sup> operating cycles	Max. 10 <sup>6</sup> operating cycles
Rated surge voltage	4 kV	4 kV
Short-circuit protection, max.	10 A	10 A
Maximum operating frequency	1800 operating cycles/h	1800 operating cycles/h
Ambient Conditions		
Ambient temperature	-40 °C ... +70 °C (T6) -40 °C ... +70 °C (T5)	-20 °C ... +40 °C (T6) -20 °C ... +60 °C (T5)
Mechanical Data		
Degree of protection (IP) (IEC 60529)	IP66	IP66
Cover material	1.4401 blasted stainless steel	1.4401 blasted stainless steel
Enclosure material	Corrosion-resistant aluminium, powder-coated	Corrosion-resistant aluminium, powder-coated
Max. earth connection	4 mm <sup>2</sup>	4 mm <sup>2</sup>
Contact material	Silver-nickel	Silver-nickel
Finely stranded connection cross section	0.75 – 2.5 mm <sup>2</sup>	0.75 – 1.5 mm <sup>2</sup>
Solid connection cross section	0.75 – 2.5 mm <sup>2</sup>	0.75 – 1.5 mm <sup>2</sup>
Contact system	2-pole, galvanically separated with double break	2-pole, galvanically separated with double break
Contact opening	≥ 1.5 mm (isolating distance ≥ 3 mm)	≥ 1.5 mm (isolating distance ≥ 3 mm)
Components		
Cable glands and entries	1 x M20 Ø 4 ... 13 mm	1 x M20 Ø 4 ... 13 mm
Cable entry material	Polyamide	Polyamide
Material cable gland	Polyamide, Glass fibre reinforced	Polyamide, Glass fibre reinforced

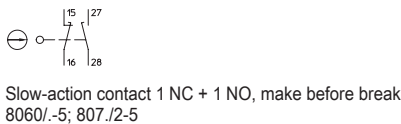
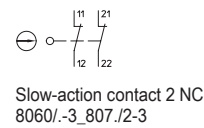
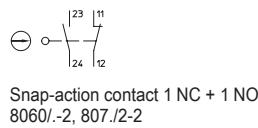
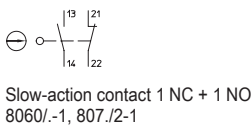
### Technical Drawings – Subject to Alterations

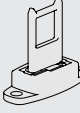

Accessories				
Figure	Description	Art. No.	Weight	
<b>Actuator</b>				
	Straight, for 8074/2--AZ	132311	28 g	
	Angled, for 8074/2--AZ	132312	37 g	
	Adjustable, for 8074/2--AZ	132313	35 g	
<b>Cable gland made of plastic</b>				
	8161/7-M20-1307, Ex e Plastic, M20 x 1.5, cable outer diameter 7 to 13 mm Lot size 50 pieces	239172	13 g	

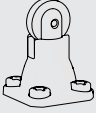
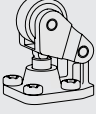
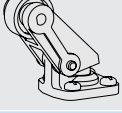
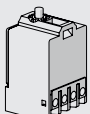
Spare Parts				
Figure	Description	Art. No.	Weight	
<b>Actuator</b>				
	Rotary lever actuator	257533	102 g	
	Long rotary lever actuator	257534	102 g	
	Roller plunger actuator	257520	102 g	
	Roller lever actuator	278460	-	
	Parallel roller lever actuator	278574	-	
<b>Contact element</b>				
	1 NC + 1 NO slow-action contact 8080/1-1	132529	25 g	
	1 NC + 1 NO slow-action contact 8080/1-2	279482	25 g	
	2 NC slow-action contact 8080/1-3	132532	25 g	

Lot size: Purchase order quantity in [pieces], the delivery quantity is automatically rounded to the lot size.

Dimensional Drawings (All Dimensions in mm [inches]) – Subject to Alterations

E4

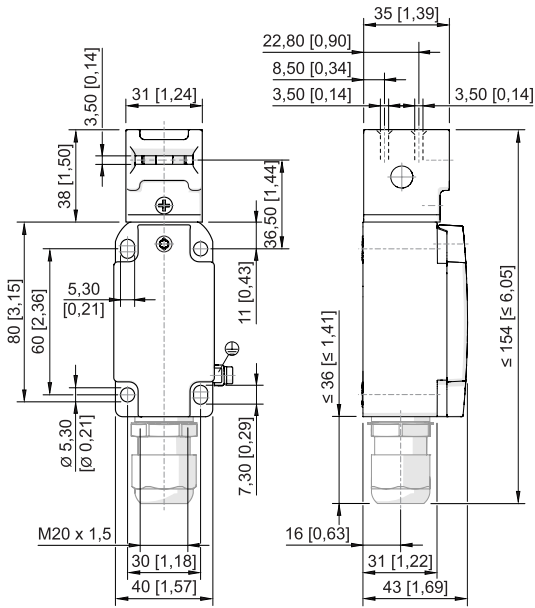

Safety switch 8074/2--AZ-20

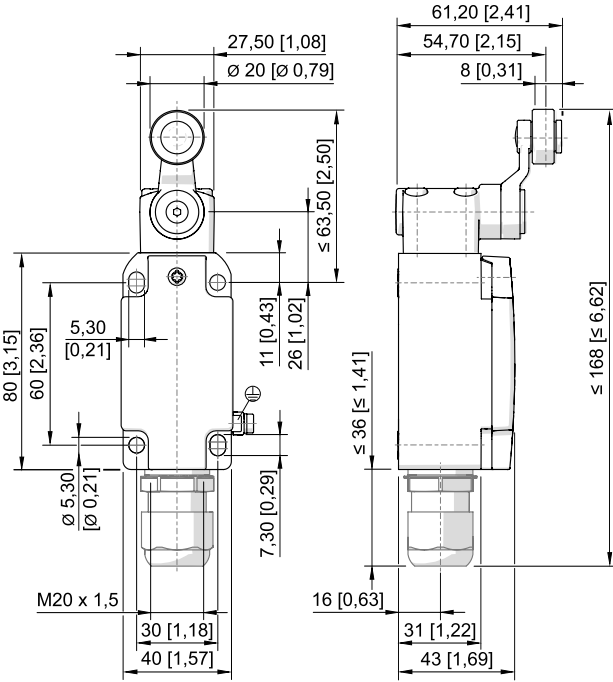

Swivelling lever 8074/2--D-40

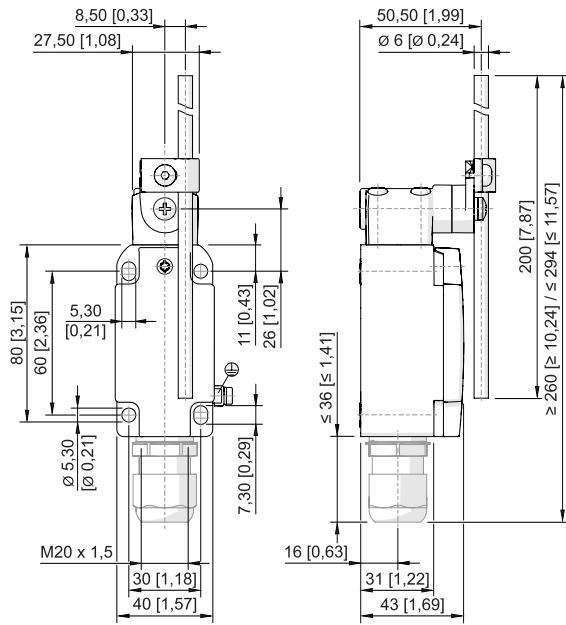

Roller lever 8074/2--DD-40

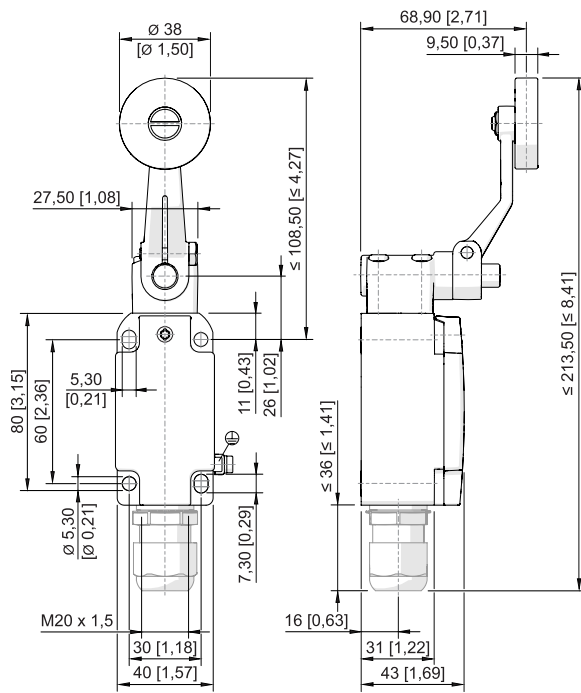

Swivelling lever 8074/2--DL-40

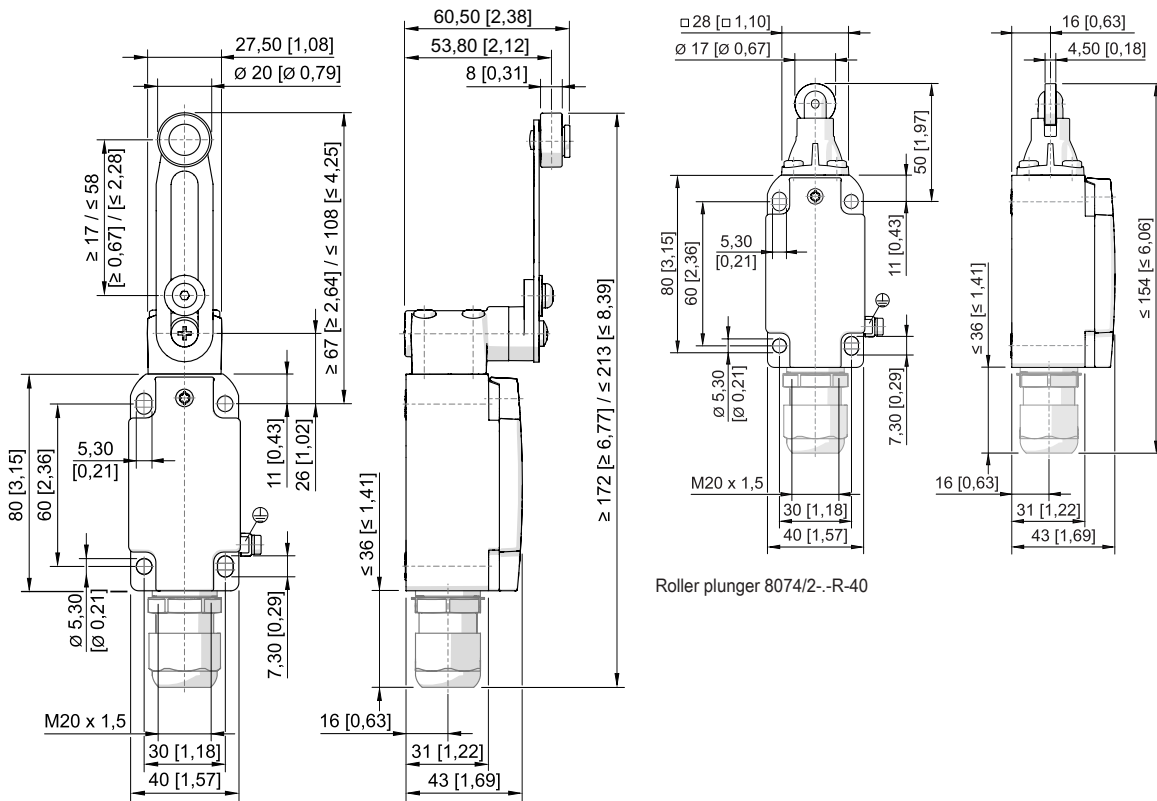

Swivelling lever 8074/2--DS-40

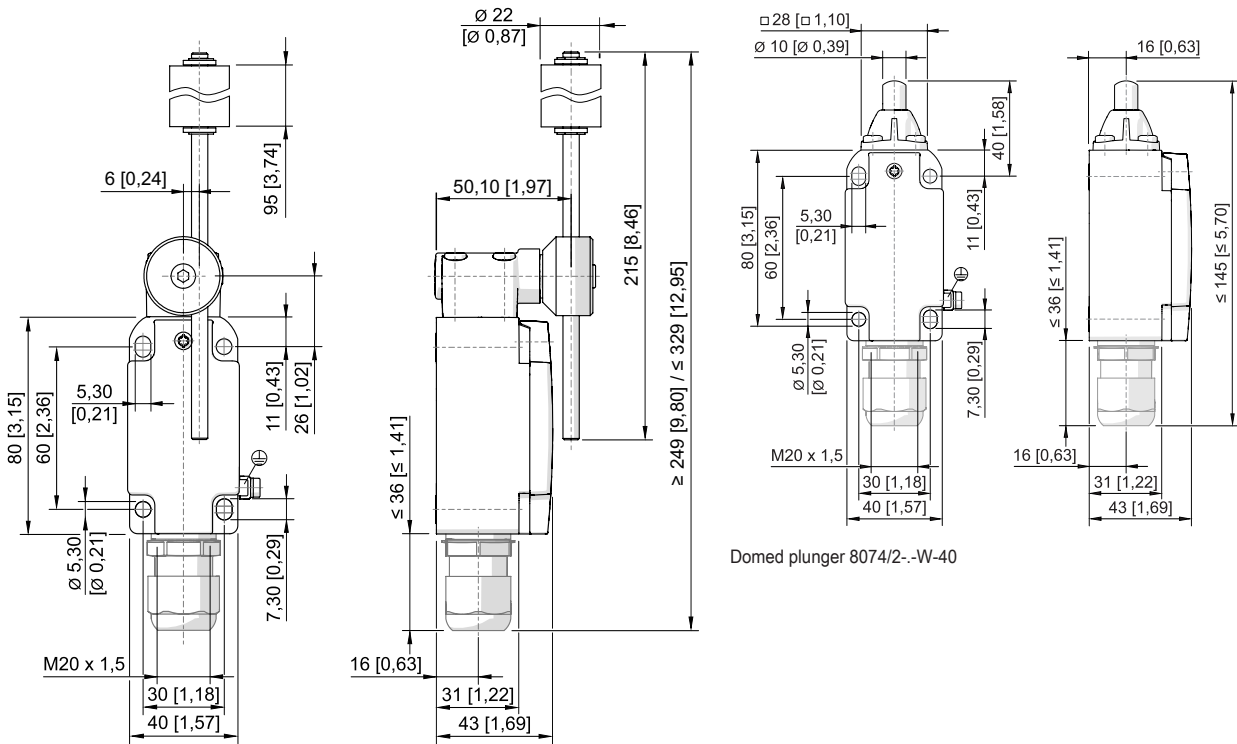

Belt-alignment switch 8074/2--SR-40

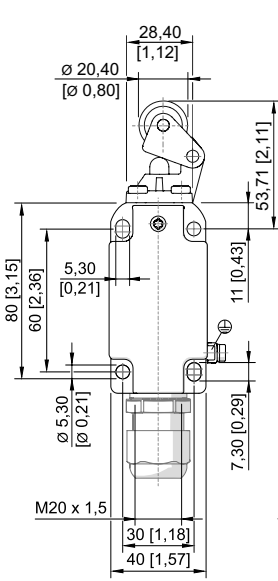

Roller lever 8074/2--WH-40

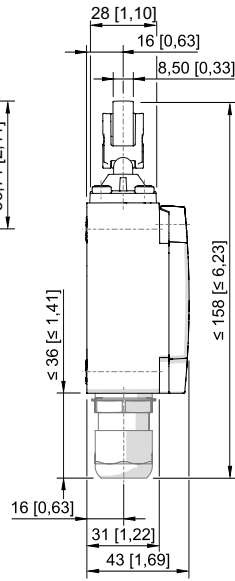

Roller lever 8074/2--WPH-40

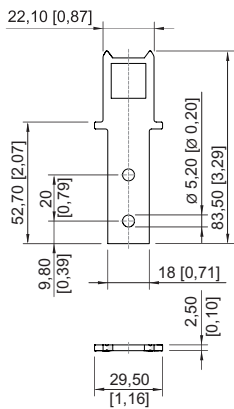

Straight actuator for safety switch

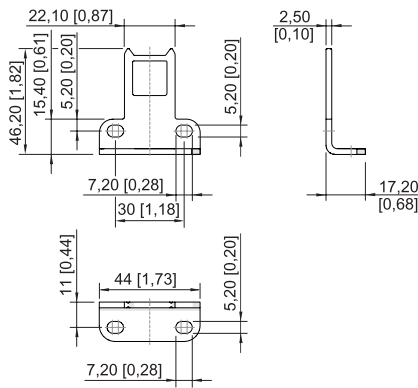

Angled actuator for safety switch

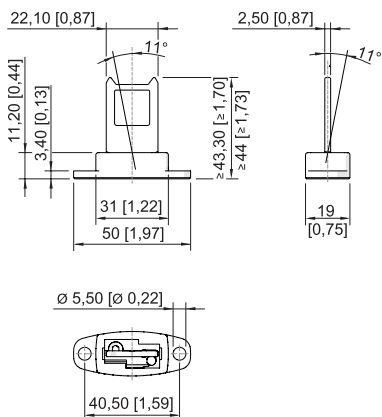

Adjustable actuator for safety switch