



- Resistant Ex i terminal boxes made of stainless steel, degree of protection IP66, external earth connection M8
- Version as screw-on cover or hinge cover with sash locks
- Equipped as required

E3

MY R. STAHL 8150H



R. STAHL Series 8150 Ex i terminal boxes are made of brushed stainless steel (1.4301, AISI 304 or 1.4404, AISI 316L) and are particularly resistant. The optimised design and the circumferential protection channel on the cover opening and the silicone seal suitable for the most extreme temperature ranges make the enclosure usable worldwide. Various optional accessories are available.

| | IECEX / ATEX | | | | | |
|-----------------|--------------|---|---|----|----|----|
| Zone | 0 | 1 | 2 | 20 | 21 | 22 |
| Installation in | | • | • | | • | • |

| Selection Table | | | | | | | |
|---------------------|---------------------------|---|--|------------------|---|----------|---------|
| Product Description | | Ex i terminal box | | | | | |
| Enclosure material | | Stainless steel 1.4301, (AISI 304), brush finished | | | | | |
| Figure | Product Type | Dimensions (WxHxD) | Type of terminals 1 | Terminal rail | Max. no. of 2.5 mm ² terminals | Art. No. | Weight |
| | 8150/2-0360-0360-150-2311 | 360 x 360 x 150 mm | 1 x Phoenix UT 2-conductor, 2.5 mm ² , blue | 35 x 301 mm (1x) | 52 | 275143 | 4.27 kg |
| | 8150/2-0360-0176-150-2311 | 360 x 176.5 x 150 mm | 1 x Phoenix UT 2-conductor, 2.5 mm ² , blue | 35 x 301 mm (1x) | 52 | 275146 | 3.75 kg |
| | 8150/2-0176-0116-091-2311 | 176.5 x 116.5 x 91 mm | 1 x Phoenix UT 2-conductor, 2.5 mm ² , blue | 35 x 133 mm (1x) | 19 | 275141 | 2.25 kg |
| Product Description | | Ex i terminal box | | | | | |
| Enclosure material | | Stainless steel 1.4404, (AISI 316L), brush finished | | | | | |
| Figure | Product Type | Dimensions (WxHxD) | Type of terminals 1 | Terminal rail | Max. no. of 2.5 mm ² terminals | Art. No. | Weight |
| | 8150/2-0236-0176-091-3311 | 236.5 x 176.5 x 91 mm | 1 x Phoenix UT 2-conductor, 2.5 mm ² , blue | 35 x 189 mm (1x) | 27 | 275147 | 3.09 kg |
| | 8150/2-0176-0116-091-3311 | 176.5 x 116.5 x 91 mm | 1 x Phoenix UT 2-conductor, 2.5 mm ² , blue | 35 x 133 mm (1x) | 19 | 275148 | 2.25 kg |

Hinges can be ordered as accessories.

| Technical Data | |
|--|--|
| Explosion Protection | |
| IECEX gas explosion protection | Ex ia ib IIC T6 Gb |
| IECEX dust explosion protection | Ex tb IIIIC T80 °C Db |
| ATEX gas explosion protection | II 2 G Ex ia ib IIC T6 Gb |
| ATEX dust explosion protection | II 2 D Ex tb IIIIC T80 °C Db |
| Certificates | ATEX (PTB), IECEX (PTB), India (PESO), Korea (KGS), Taiwan (ITRI) |
| Notes | Product label may vary. Series devices have certification according to ATEX and IECEX. |
| Electrical Data | |
| Rated operational voltage AC | 0 ... 60 V |
| Notes | depend on the terminal type used and the explosion protected components |
| Ambient Conditions | |
| Ambient temperature | -60 °C ... +75 °C |
| Mechanical Data | |
| Degree of protection IP (IEC 60529) | IP66 |
| External protective conductor connection | M8 |
| Silicone-free | No |
| Connection cross-section | 2.5 mm ² |
| Components | |
| Notes | Please refer to the manufacturer's terminal data, e. g. the tightening torque |

| Accessories | | | |
|---|---|----------|--------|
| Figure | Description | Art. No. | Weight |
| Screw hinge assembly kit | | | |
|  | Retrofittable hinge for enclosure up to max. 400 x 400 mm | 275739 | 66 g |

Dimensional Drawings (All Dimensions in mm [inches]) – Subject to Alterations

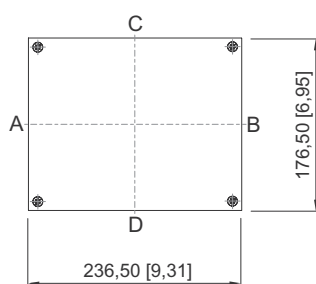
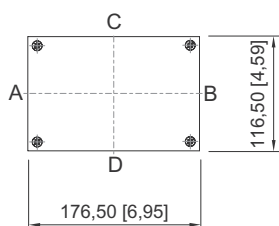
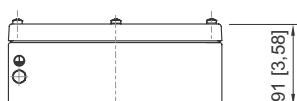
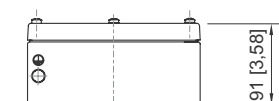

8150/-0176-0116-091-..1.

8150/-0236-0176-091-..1.

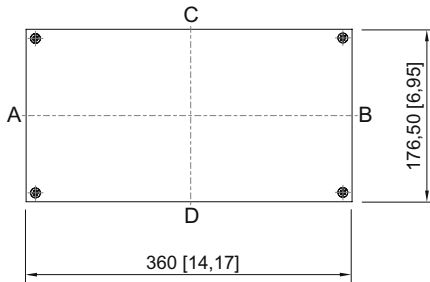
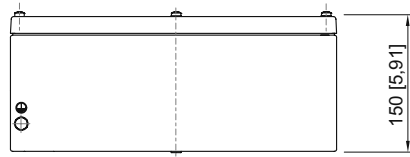
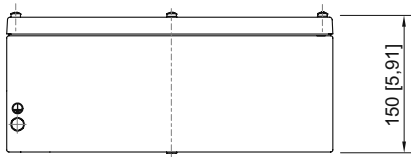

8150/-0360-0176-150-..1.

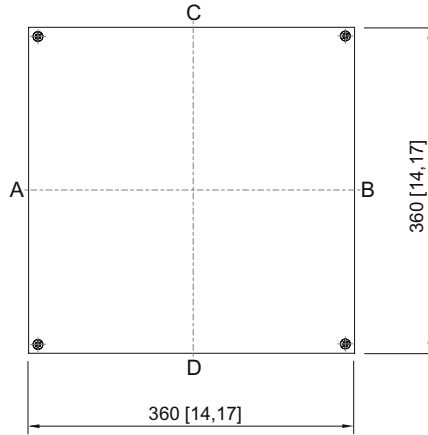

8150/-0360-0360-150-..1.