



- The latest LED technology with a high luminous efficacy and a long service life
- Extremely high luminaire efficacy
- Luminous flux after 100,000 h still 90% of the starting luminous flux
- Optionally with DALI for controlling and monitoring the luminaire
- Optionally addressable for direct actuation of a common battery system

E2

MY R. STAHL 6002D



The linear luminaire with Series 6002/4 LED is ideal for lighting surfaces at a mounting height of up to 10 m. It can also be used to illuminate equipment and objects, both inside and outside. The pole mounting sleeve accessory can be used to easily mount the luminaire on poles. Optionally, the luminaire can be equipped with addressable equipment. It can be used to control and monitor the luminaire for the common battery systems.

	IECEX / ATEX					
Zone	0	1	2	20	21	22
Installation in		•	•		•	•

Selection Table										
Size	2									
Translucent cover	Clear									
Light distribution	120°x120° with diffusing glass									
Lamp wattage	22 W									
Luminous flux	2910 lm									
Luminaire efficacy	132 lm/W									
Ambient temperature	-40 °C ... +50 °C Note: Through wiring Max. 3x16 A -40 °C ... +60 °C Note: Through wiring 2 Max. 3x10 A									
Product variant	Drilled holes	Light colour	Disconnection of the luminaire	Cable glands and entries	Stopping plugs	Diffuser	Threaded plate	Product Type	Art. No.	Weight
-	3 x M25	4000 K – warm neutral white	No	2 x M25 Ø 7 ...	2 x M25 x 1.5	With diffuser	2x plastic	6002/4128-0100-152-1110-11-8400	272497	4.45 kg
		5000 K – neutral white	Yes	2 x M25 Ø 7 ...	2 x M25 x 1.5	With diffuser	2x plastic	6002/4128-0101-152-1110-11-8500	275778	4.45 kg
Interfaces DALI	3 x M25	4000 K – warm neutral white	No	2 x M25 Ø 7 ...	2 x M25 x 1.5	With diffuser	2x plastic	6002/4128-0110-172-1110-11-8400	272390	4.45 kg
		5000 K – neutral white	No	2 x M25 Ø 7 ...	2 x M25 x 1.5	With diffuser	2x plastic	6002/4128-0110-172-1110-11-8500	272391	4.45 kg
standard	3 x M20	5000 K – neutral white	No	Can be ordered as accessories	Can be ordered as accessories	With diffuser	2x SS430 stainless steel	6002/4128-0100-152-2220-22-8500	267067	4.4 kg
	3 x M25	5000 K – neutral white	No	2 x M25 Ø 7 ...	2 x M25 x 1.5	With diffuser	2x plastic	6002/4128-0100-152-1110-11-8500	267058	4.45 kg
		6500 K – daylight white	No	2 x M25 Ø 7 ...	2 x M25 x 1.5	With diffuser	2x plastic	6002/4128-0100-152-1110-11-8650	288961	4.45 kg

Selection Table

Size		2								
Translucent cover		Clear								
Light distribution		120°x120° with diffusing glass								
Lamp wattage		22 W								
Luminous flux		2910 lm								
Luminaire efficacy		132 lm/W								
Ambient temperature		-30 °C ... +50 °C Note: Through wiring Max. 3x16 A								
-30 °C ... +60 °C Note: Through wiring 2 Max. 3x10 A										
Product variant	Drilled holes	Light colour	Disconnection of the luminaire	Cable glands and entries	Stopping plugs	Diffuser	Threaded plate	Product Type	Art. No.	Weight
with address module	3 x M25	5000 K – neutral white	No	2 x M25 Ø 7 ...	2 x M25 x 1.5	With diffuser	2x plastic	6002/4128-0130-152-1110-11-8500	275740	4.5 kg
Size		2								
Translucent cover		Translucent								
Light distribution		120°x120°								
Lamp wattage		22 W								
Luminous flux		2550 lm								
Luminaire efficacy		116 lm/W								
Ambient temperature		-40 °C ... +50 °C Note: Through wiring Max. 3x16 A								
-40 °C ... +60 °C Note: Through wiring 2 Max. 3x10 A										
Product variant	Drilled holes	Light colour	Disconnection of the luminaire	Cable glands and entries	Stopping plugs	Diffuser	Threaded plate	Product Type	Art. No.	Weight
standard	3 x M20	5000 K – neutral white	No	Can be ordered as accessories	Can be ordered as accessories	Without diffuser	2x SS430 stainless steel	6002/4124-0100-152-2220-22-850S	285108	4.35 kg
	3 x M25	5000 K – neutral white	No	2 x M25 Ø 7 ...	2 x M25 x 1.5	Without diffuser	2x plastic	6002/4124-0100-152-1110-11-850S	285105	4.4 kg
Size		4								
Translucent cover		Clear								
Light distribution		120°x120° with diffusing glass								
Lamp wattage		42 W								
Luminous flux		5810 lm								
Luminaire efficacy		138 lm/W								
Ambient temperature		-40 °C ... +50 °C Note: Through wiring Max. 3x16 A								
-40 °C ... +60 °C Note: Through wiring 2 Max. 3x10 A										
Product variant	Drilled holes	Light colour	Disconnection of the luminaire	Cable glands and entries	Stopping plugs	Diffuser	Threaded plate	Product Type	Art. No.	Weight
–	3 x M25	4000 K – warm neutral white	No	2 x M25 Ø 7 ...	2 x M25 x 1.5	With diffuser	2x plastic	6002/4148-0100-152-1110-11-8400	272498	6.9 kg
		6500 K – daylight white	No	2 x M25 Ø 7 ...	2 x M25 x 1.5	With diffuser	2x plastic	6002/4148-0100-152-1110-11-8650	277614	6.9 kg
		5000 K – neutral white	Yes	2 x M25 Ø 7 ...	2 x M25 x 1.5	With diffuser	2x plastic	6002/4148-0101-152-1110-11-8500	272258	6.9 kg
Interfaces DALI	3 x M20	5000 K – neutral white	No	Can be ordered as accessories	Can be ordered as accessories	With diffuser	2x SS430 stainless steel	6002/4148-0110-172-2220-22-8500	274963	6.9 kg
		4000 K – warm neutral white	No	2 x M25 Ø 7 ...	2 x M25 x 1.5	With diffuser	2x plastic	6002/4148-0110-172-1110-11-8400	272398	6.9 kg
		5000 K – neutral white	No	2 x M25 Ø 7 ...	2 x M25 x 1.5	With diffuser	2x plastic	6002/4148-0110-172-1110-11-8500	267087	6.9 kg
standard	3 x M20	5000 K – neutral white	No	Can be ordered as accessories	Can be ordered as accessories	With diffuser	2x SS430 stainless steel	6002/4148-0100-152-2220-22-8500	267077	6.9 kg
		5000 K – neutral white	No	2 x M25 Ø 7 ...	2 x M25 x 1.5	With diffuser	2x plastic	6002/4148-0100-152-1110-11-8500	267074	6.9 kg

Selection Table										
Size			4							
Translucent cover			Clear							
Light distribution			120°x120° with diffusing glass							
Lamp wattage			42 W							
Luminous flux			5810 lm							
Luminaire efficacy			138 lm/W							
Ambient temperature			-30 °C ... +50 °C Note: Through wiring Max. 3x16 A -30 °C ... +60 °C Note: Through wiring 2 Max. 3x10 A							
Product variant	Drilled holes	Light colour	Disconnection of the luminaire	Cable glands and entries	Stopping plugs	Diffuser	Threaded plate	Product Type	Art. No.	Weight
with address module	3 x M20	5000 K – neutral white	No	Can be ordered as accessories	Can be ordered as accessories	With diffuser	2x SS430 stainless steel	6002/4148-0130-152-2220-22-8500	277241	6.9 kg
	3 x M25	4000 K – warm neutral white	No	2 x M25 Ø 7 ...	2 x M25 x 1.5	With diffuser	2x plastic	6002/4148-0130-152-1110-11-8400	276553	6.9 kg
		5000 K – neutral white	No	2 x M25 Ø 7 ...	2 x M25 x 1.5	With diffuser	2x plastic	6002/4148-0130-152-1110-11-8500	275741	6.9 kg
Size			4							
Translucent cover			Translucent							
Light distribution			120°x120°							
Lamp wattage			42 W							
Luminous flux			5100 lm							
Luminaire efficacy			121 lm/W							
Ambient temperature			-40 °C ... +50 °C Note: Through wiring Max. 3x16 A -40 °C ... +60 °C Note: Through wiring 2 Max. 3x10 A							
Product variant	Drilled holes	Light colour	Disconnection of the luminaire	Cable glands and entries	Stopping plugs	Diffuser	Threaded plate	Product Type	Art. No.	Weight
standard	3 x M20	5000 K – neutral white	No	Can be ordered as accessories	Can be ordered as accessories	Without diffuser	2x SS430 stainless steel	6002/4144-0100-152-2220-22-850S	285109	6.85 kg
	3 x M25	5000 K – neutral white	No	2 x M25 Ø 7 ...	2 x M25 x 1.5	Without diffuser	2x plastic	6002/4144-0100-152-1110-11-850S	285106	6.85 kg
		6500 K – daylight white	No	2 x M25 Ø 7 ...	2 x M25 x 1.5	Without diffuser	2x plastic	6002/4144-0100-152-1110-11-865S	285107	6.85 kg
Size			6							
Translucent cover			Clear							
Light distribution			120°x120° with diffusing glass							
Lamp wattage			50 W							
Luminous flux			6960 lm							
Luminaire efficacy			139 lm/W							
Ambient temperature			-20 °C ... +50 °C Note: Through wiring Max. 3x16 A -20 °C ... +60 °C Note: Through wiring 2 Max. 3x10 A							
Product variant	Drilled holes	Light colour	Disconnection of the luminaire	Cable glands and entries	Stopping plugs	Diffuser	Threaded plate	Product Type	Art. No.	Weight
–	3 x M25	4000 K – warm neutral white	No	2 x M25 Ø 7 ...	2 x M25 x 1.5	With diffuser	2x plastic	6002/4168-0200-152-1110-11-8400	278348	8 kg
		4000 K – warm neutral white	Yes	2 x M25 Ø 7 ...	2 x M25 x 1.5	With diffuser	2x plastic	6002/4168-0201-152-1110-11-8400	276336	8 kg
		6500 K – daylight white	Yes	2 x M25 Ø 7 ...	2 x M25 x 1.5	With diffuser	2x plastic	6002/4168-0201-152-1110-11-8650	276337	8 kg
standard	3 x M20	5000 K – neutral white	No	Can be ordered as accessories	Can be ordered as accessories	With diffuser	2x SS430 stainless steel	6002/4168-0200-152-2220-22-8500	278346	8 kg
	3 x M25	5000 K – neutral white	No	2 x M25 Ø 7 ...	2 x M25 x 1.5	With diffuser	2x plastic	6002/4168-0200-152-1110-11-8500	278349	8 kg
		5000 K – neutral white	Yes	2 x M25 Ø 7 ...	2 x M25 x 1.5	With diffuser	2x plastic	6002/4168-0201-152-1110-11-8500	276335	8 kg

Selection Table

Size	6
Translucent cover	Translucent
Light distribution	120°x120°
Lamp wattage	50 W
Luminous flux	6000 lm
Luminaire efficacy	120 lm/W
Ambient temperature	-20 °C ... +50 °C Note: Through wiring Max. 3x16 A -20 °C ... +60 °C Note: Through wiring 2 Max. 3x10 A

Product variant	Drilled holes	Light colour	Disconnection of the luminaire	Cable glands and entries	Stopping plugs	Diffuser	Threaded plate	Product Type	Art. No.	Weight
-	3 x M25	5000 K – neutral white	No	2 x M25 Ø 7 ...	2 x M25 x 1.5	Without diffuser	2x plastic	6002/4164-0200-152-1110-11-850S	288600	8 kg

Variants with 2 x threaded plate plastic and 3 x drilled holes M25:

Cable glands 2 x M25 Ø 7 -17 mm and 2 x stopping plugs M 25 x 1,5 are included loose with the product (installation required). Threaded plate included.

Variants with 2 x threaded plate stainless steel SS430 and 3 x drilled holes M20:

Cable glands and stopping plugs can be ordered as accessories. Threaded plate included.

The light fittings are supplied without mounting material.

Technical Data

Variant	standard / product variant "-"	Interfaces DALI	with address module
Explosion Protection			
IECEX gas explosion protection	Ex db eb ib op is IIC T4 Gb	Ex db eb ib op is IIC T4 Gb	Ex db eb ib op is IIC T4 Gb
IECEX dust explosion protection	Ex tb op is IIIC T100 °C Db	Ex tb op is IIIC T100 °C Db	Ex tb op is IIIC T100 °C Db
ATEX gas explosion protection	⊕ II 2 G Ex db eb ib op is IIC T4 Gb	⊕ II 2 G Ex db eb ib op is IIC T4 Gb	⊕ II 2 G Ex db eb ib op is IIC T4 Gb
ATEX dust explosion protection	⊕ II 2 D Ex tb op is IIIC T100 °C Db	⊕ II 2 D Ex tb op is IIIC T100 °C Db	⊕ II 2 D Ex tb op is IIIC T100 °C Db
Certificates	ATEX (IBE), IECEX (IBE), India (PESO)	ATEX (IBE), IECEX (IBE), India (PESO)	ATEX (IBE), IECEX (IBE), India (PESO)
Ship approval	DNV	DNV	DNV
Declaration of Conformity	ATEX (EUK), Declaration of Conformity (AUS)	ATEX (EUK), Declaration of Conformity (AUS)	ATEX (EUK), Declaration of Conformity (AUS)
Electrical Data			
Rated operational voltage AC	100 – 240 V	100 – 240 V	220 – 240 V
Rated operational voltage DC	110 ... 250 V	110 ... 250 V	194 ... 250 V
Frequency range	50 – 60 Hz	50 – 60 Hz	50 Hz
Lighting Data			
Number of lamps	1	1	1
Lamp	LED	LED	LED
Colour rendering	≥ 80	≥ 80	≥ 80
Colour temperature	5000 K	4000 K	5000 K
Mechanical Data			
Impact strength (IEC 62262)	IK10	IK10	IK10
IP degree of protection (IEC 60598)	IP66/IP67	IP66/IP67	IP66/IP67
Enclosure colour	Light grey (RAL 7035)	Light grey (RAL 7035)	Light grey (RAL 7035)
Enclosure material	Polyester resin, Glass fibre reinforced	Polyester resin, Glass fibre reinforced	Polyester resin, Glass fibre reinforced
Sealing material	Silicone	Silicone	Silicone
Max. solid connection terminals	6 mm ²	6 mm ²	6 mm ²
Max. finely stranded connection terminals	4 mm ²	4 mm ²	4 mm ²
Type of connection cable	Finely stranded Solid	Finely stranded Solid	Finely stranded Solid
Notes	Connection terminals: Spring clamp terminal (2 free clamping units per pole)		
Components			
Ballast	6045/311-120-10	6045/311-121-10	6045/312-122-10
Through wiring	With 5 conductors 2.5 mm ²	With 7 conductors 2.5 mm ²	With 5 conductors 2.5 mm ²
Cable entry material	Polyamide, black	Polyamide, black	Polyamide, black

Technical Data			
Variant	standard / product variant "-"	Interfaces DALI	with address module
Components			
Stopping plug material	Polyamide, black	Polyamide, black	Polyamide, black

Light Distribution Curves – Subject to Alterations

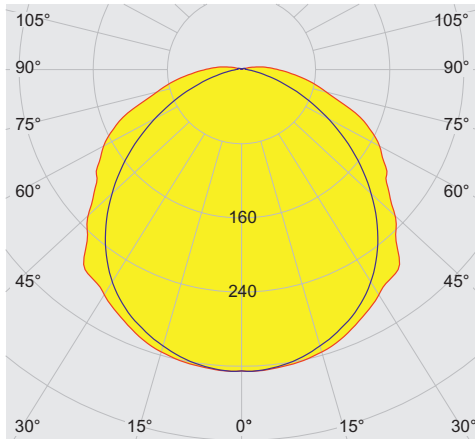



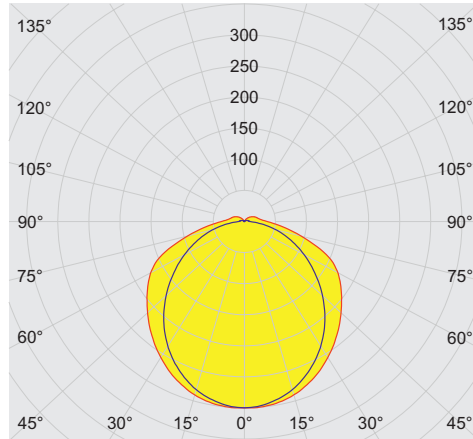

cd/klm 100%
 — C0 - C180 — C90 - C270
 typical with diffuser, clear translucent cover





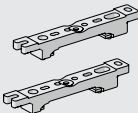
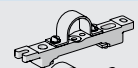

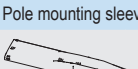
cd/klm 100%
 — C0 - C180 — C90 - C270
 typical without diffuser, diffuse translucent cover

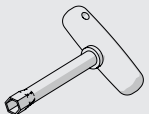
Accessories

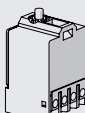
Figure	Description	Art. No.	Weight
Breather			
	Thread: M25 x 1.5 (20 pieces); without jam nut	285780	200 g
	Thread: M25 x 1.5 (1 piece); for installation in light fittings; made from stainless steel; without jam nut	296608	-
Ceiling and wall mounting bracket			
	mounted on a mounting rail for a variable mounting distance; Material: stainless steel; Lamp can be swiveled in steps of 15°; 1 pair	222827	1.2 kg
Cover			
	For size 2 luminaires (diffuse), when used on an emergency luminaire with individual power supply, the visibility of the display LED may be restricted	276669	1 kg
	For size 4 luminaires (diffuse), when used on an emergency luminaire with individual power supply, the visibility of the display LED may be restricted	276670	1.2 kg
Mounting bracket			
	mounting clamp mounted on a mounting rail for a variable mounting distance; 1 pair	222456	400 g

Accessories			
Figure	Description	Art. No.	Weight
Mounting rail			
	for a variable mounting distance; 1 pair	222826	350 g
Pipe clamp			
	R 1 1/2"; with mounting rail for a variable mounting distance; material: stainless steel; 1 pair	222459	700 g
	R 1 1/4"; with mounting rail for a variable mounting distance; Material: stainless steel; 1 pair	222458	700 g
	R 2"; with mounting rail for a variable mounting distance; Material: stainless steel; 1 pair	222460	750 g
Pole mounting sleeve			
	for the subsequent mounting on lights size 2 and size 4, completely with assembly parts (for pipe diameter 42 mm)	227512	3.2 kg
Ring bolt			
	M8, direct mounting in insert nuts; 1 pair	115736	115 g
Socket key			
	M8 / A/F 13; For actuating the central lock	222430	110 g

Spare Parts			
Figure	Description	Art. No.	Weight
Contact element			
	8080/1-3-L 2 NC contact element	132527	26 g
Cover			
	for luminaire size 4	222428	1.15 kg
	for luminaire size 6	222429	1.45 kg
	for luminaire size 2	222427	639 g
Reflector Plate			
	Spare part for 6002 or upgrade 6001 size 2, colour temperature 4000 K	272064	2.1 kg
	Spare part for 6002 or upgrade 6001 size 2, colour temperature 5000 K	270812	2.1 kg
	Spare part for 6002 or upgrade 6001 size 2, colour temperature 6500 K	272066	2.1 kg
	Spare part for 6002 or upgrade 6001 size 4, colour temperature 4000 K	272063	2.6 kg
	Spare part for 6002 or upgrade 6001 size 4, colour temperature 5000 K	270813	2.6 kg
	Spare part for 6002 or upgrade 6001 size 4, colour temperature 6500 K	272065	2.6 kg

Dimensional Drawings (All Dimensions in mm [inches]) – Subject to Alterations

E2

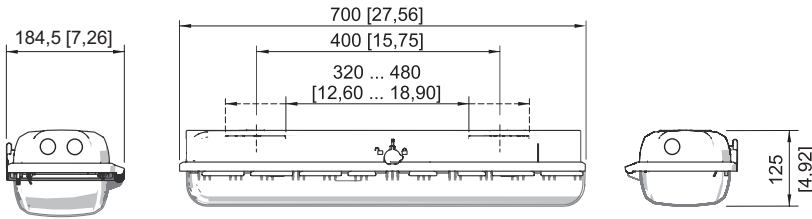

Size 2

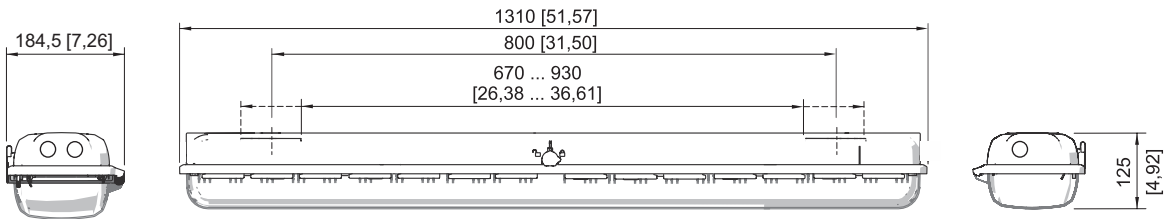

Size 4

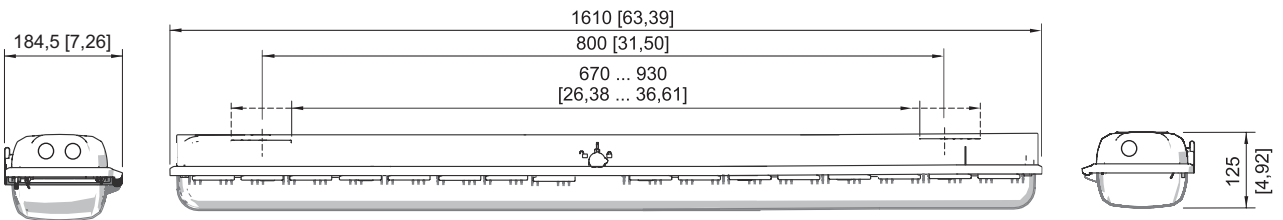

Size 6

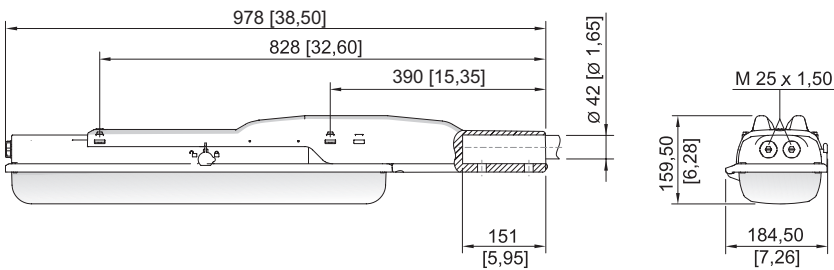

Size 2

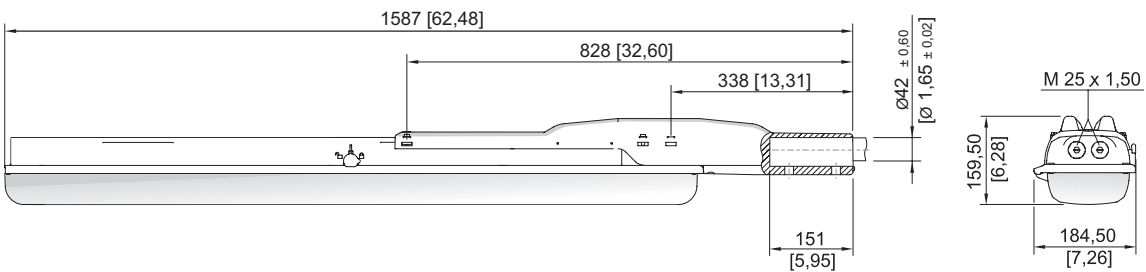

Size 4

E2

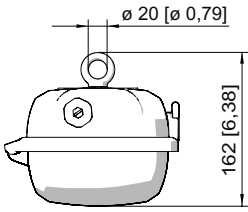

Ring bolt fitted in insert nut of the luminaire

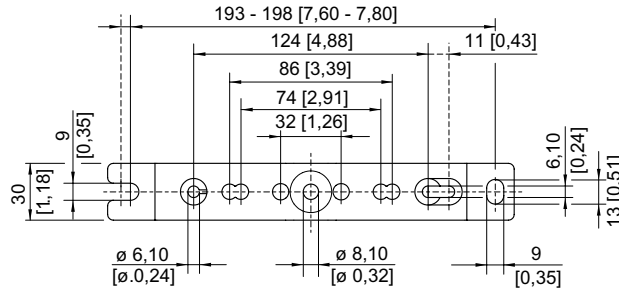
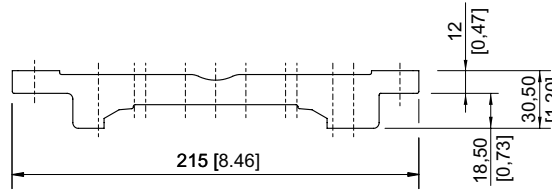

Mounting rail

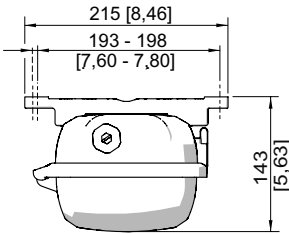

Mounting rail

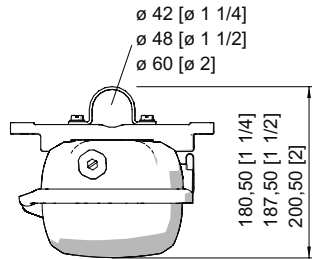

Pipe clamp fitted in mounting rail

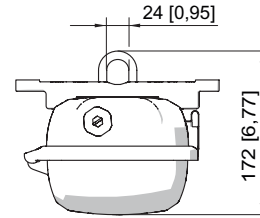

Mounting bracket fitted in mounting rail

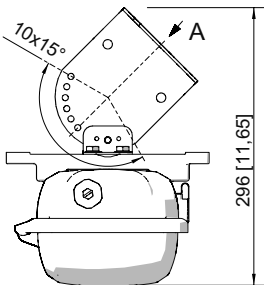

A

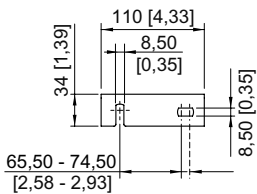

Wall mounting bracket fitted in mounting rail

Start-up current

$I_{peak} = 51 \text{ A}$; $\Delta t = 127 \mu\text{s}$

E2

Maximum number of luminaires per miniature circuit breaker:

Type	10 A	16 A	20 A	25 A
B	12	19	24	31
C	20	33	41	51
K	41	66	82	103

typical value for 1-pole miniature circuit breaker at +25 °C and nominal voltage 230 V AC; the exact number depends on the miniature circuit breaker used