

# Lighting

## Linear luminaire With LED

GRP

6002/4148-0100-152-2220-22-8400 Art. No. 284084



- The latest LED technology with a high luminous efficacy and a long service life
- Extremely high luminaire efficacy
- Luminous flux after 100,000 h still 90% of the starting luminous flux
- Optionally with DALI for controlling and monitoring the luminaire
- Optionally addressable for direct actuation of a common battery system

MY R. STAHL 6002D



The linear luminaire with Series 6002/4 LED is ideal for lighting surfaces at a mounting height of up to 10 m. It can also be used to illuminate equipment and objects, both inside and outside. The pole mounting sleeve accessory can be used to easily mount the luminaire on poles. Optionally, the luminaire can be equipped with addressable equipment. It can be used to control and monitor the luminaire for the common battery systems.

### Technical Data

#### Explosion Protection

Ex version	Yes
Application range (zones)	1, 2, 21, 22
IECEX gas certificate	IECEX IBE 14.0035
IECEX gas certificate	IECEX IBE 14.0035
IECEX gas explosion protection	Ex db eb ib op is IIC T4 Gb
IECEX dust certificate	IECEX IBE 14.0035
IECEX dust explosion protection	Ex tb op is IIIC T100 °C Db
ATEX gas certificate	IBExU 14ATEX1088
ATEX gas certificate	IBExU 14ATEX1088
ATEX gas explosion protection	⊕ II 2 G Ex db eb ib op is IIC T4 Gb
ATEX dust certificate	IBExU 14ATEX1088
ATEX dust explosion protection	⊕ II 2 D Ex tb op is IIIC T100 °C Db
Certificates and approvals	ATEX IECEX UKEX
Certificates	ATEX (IBE), IECEX (IBE), India (PESO)
Ship approval	DNV
Declaration of conformity	ATEX (EUK), Declaration of Conformity (AUS)

#### Electrical Data

Rated operational voltage AC	100 ... 240 V
Rated operational voltage DC	110 ... 250 V
Frequency range	50 – 60Hz

#### Lighting Data

Number of lamps	1
Lamp wattage	42 W
Lamp	LED

# Lighting

## Linear luminaire With LED

### GRP

6002/4148-0100-152-2220-22-8400 Art. No. 284084



#### Lighting Data

Light colour	4000 K – warm neutral white
Light distribution	120°x120° with diffusing glass
Luminaire efficacy	138 lm/W
Luminous flux	5810 lm
Colour rendering	≥ 80
Colour temperature	4000 K

#### Ambient Conditions

Ambient temperature	-40 °C ... 50 °C Note: Through wiring Max. 3x16 A -40 °C ... 60 °C Note: Through wiring 2 Max. 3x10 A
---------------------	--

#### Mechanical Data

Version	Standard
Translucent cover	Clear
IP degree of protection (IEC 60598)	IP66/IP67
Enclosure material	Polyester resin, Glass fibre reinforced
Enclosure colour	Light grey (RAL 7035)
Diffuser	With diffuser
Sealing material	Silicone
Silicone-free content	Contains silicone
Translucent cover material	Polycarbonate
Installed terminal strip	PE + N + L1 + L2 + L3
Max. solid connection terminals	6 mm <sup>2</sup>
Max. finely stranded connection terminals	4 mm <sup>2</sup>
Type of connection cable	Finely stranded Solid
Size	4
Width	184 mm
Height	125 mm
Length	1310 mm
Impact strength (IEC 62262)	IK10
Weight	6.9 kg
Weight	15.21 lb
Disconnection of the luminaire	No

#### Components

Threaded plate	2x SS430 stainless steel
Ballast	6045/311-120-10
Through wiring	With 5 conductors 2.5 mm <sup>2</sup>
Drilled holes	3 x M20
Cable glands and entries	can be ordered as an accessory
Stopping plugs	Can be ordered as accessories
Accessories	without

# Lighting

## Linear luminaire With LED

### GRP

6002/4148-0100-152-2220-22-8400 Art. No. 284084



#### Light Distribution Curves

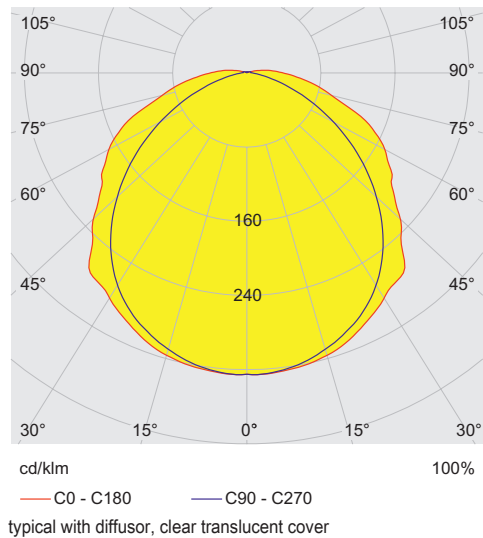

#### Dimensional Drawings (All Dimensions in mm [inches]) – Subject to Alterations

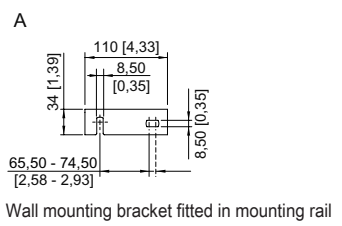
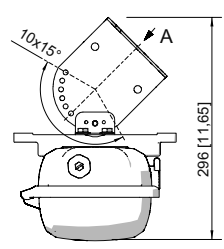
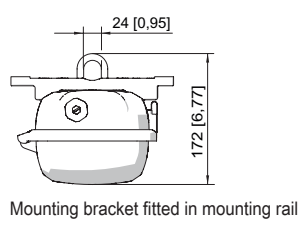
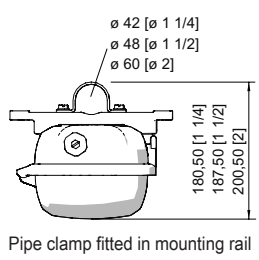
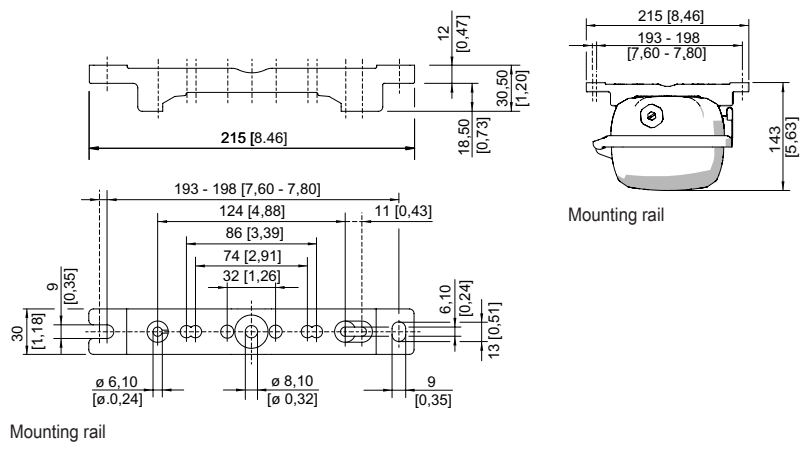
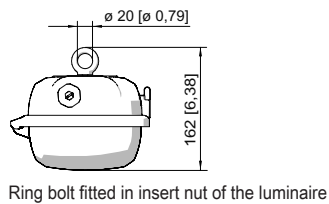

## Accessories

Box spanner

Art. No.



# Lighting

## Linear luminaire With LED

GRP

6002/4148-0100-152-2220-22-8400 Art. No. 284084

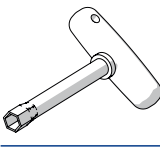
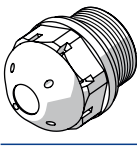
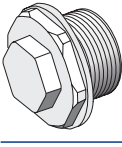
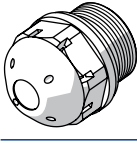
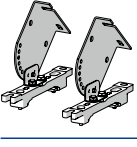

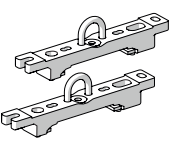
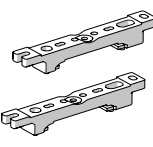
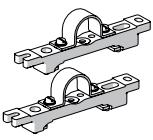
	<p>M8 / A/F 13; For actuating the central lock</p>	<p>222430</p>
<p><b>Breather</b></p>		<p><b>Art. No.</b></p>
	<p>Thread: M25 x 1.5 (20 pieces); without jam nut</p>	<p>285780</p>
	<p>Thread: M25 x 1.5 (1 piece); for installation in light fittings; made from stainless steel; without jam nut</p>	<p>296608</p>
	<p>M25 x 1.5 in order to avoid condensate formation</p>	<p>115738</p>
<p><b>Ceiling and wall mounting bracket</b></p>		<p><b>Art. No.</b></p>
	<p>mounted on a mounting rail for a variable mounting distance; Material: stainless steel; Lamp can be swiveled in steps of 15°; 1 pair</p>	<p>222827</p>
<p><b>Holder for translucent cover</b></p>		<p><b>Art. No.</b></p>
	<p>The fall prevention system for the light fitting cover prevents the light fitting cover from falling accidentally when the light fitting is opened.</p>	<p>226791</p>
<p><b>Mounting bracket</b></p>		<p><b>Art. No.</b></p>
	<p>mounting clamp mounted on a mounting rail for a variable mounting distance; 1 pair</p>	<p>222456</p>
<p><b>Mounting rail</b></p>		<p><b>Art. No.</b></p>
	<p>for a variable mounting distance; 1 pair</p>	<p>222826</p>
<p><b>Pipe clamp</b></p>		<p><b>Art. No.</b></p>
	<p>R 1 1/2"; with mounting rail for a variable mounting distance; material: stainless steel; 1 pair</p>	<p>222459</p>
	<p>R 1 1/4"; with mounting rail for a variable mounting distance; Material: stainless steel; 1 pair</p>	<p>222458</p>
	<p>R 2"; with mounting rail for a variable mounting distance; Material: stainless steel; 1 pair</p>	<p>222460</p>

# Lighting

Linear luminaire With LED

GRP

6002/4148-0100-152-2220-22-8400 Art. No. 284084



## Pole mounting sleeve

Art. No.



for the subsequent mounting on lights size 2 and size 4, completely with assembly parts (for pipe diameter 42 mm)

227512

## Protection against accidental contact

Art. No.

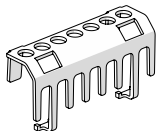

The protection against accidental contact prevents maintenance technicians and electrical installers from accidentally touching conductive parts. The degree of protection is increased to IP20 when the protection against accidental contact is used.

283153

## Ring bolt

Art. No.



M8, direct mounting in insert nuts; 1 pair

115736

## Spare Parts

### Reflector Plate

Art. No.

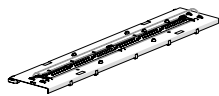

Spare part for 6002 or upgrade 6001 size 4, colour temperature 4000 K

272063

We reserve the right to make alterations to the technical data, dimensions, weights, designs and products available without notice. The illustrations cannot be considered binding.