

8169/1 Art. No. 284753



- For safe cable glands in Ex e enclosures
- Can be used in a temperature range from -35 to +75 °C, IP66 degree of protection according to IEC/EN 60529
- Silicone-free version
- Clamping ranges from 22 to 57 mm cable diameters
- One cable entry grommet can be used for six clamping ranges, assembly on site
- Optional strain relief available

MY R. STAHL 8169A

The series 8169/1 cable entry grommet is used to feed fixed conductors into electrical equipment with the increased safety type of protection.

It is approved for use in hazardous areas of Zones 1 and 2.

The cable entry grommet is mainly used in cable end boxes for distributing high currents in hazardous areas. This is because it is easy to install conductors with large cable cross-sections.

Technical Data

Explosion Protection

Ex version	Ex e & Ex i
Application range (zones)	1 2
IECEX gas certificate	IECEX CSA 21.0033U
IECEX gas explosion protection	Ex eb IIC Gb
ATEX gas certificate	CSANe 21ATEX3169U
ATEX gas explosion protection	⊕ II 2 G Ex eb IIC Gb

Mechanical Data

Strain relief	No
Degree of protection (IP)	IP66
Degree of protection note	acc. to IEC/EN 60529
Sealing material	Chloroprene rubber (CR)
Material	Chloroprene rubber (CR)
Silicone-free	Yes
Number of cables	1
Clamping range	22 – 57 mm
Armouring type	Unarmoured cable types
Armouring type note	with armoured cables, the earthing must be in the enclosure
Wall mounting thickness	5 – 5.8 mm
Wall mounting thickness note	Installation in flange or enclosure wall made of plastic or metal possible
Impact strength (IEC 60079)	7 J
Colour	Black
Weight	170 g
Weight	0.37 lb

Installation Equipment and Accessories

Cable entry grommet



8169/1 Art. No. 284753

Mounting / Installation

Mounting orientation	Lateral Bottom
----------------------	-------------------

Dimensional Drawings (All Dimensions in mm [inches]) – Subject to Alterations

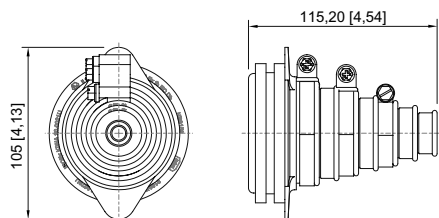

Accessories

Lubricant

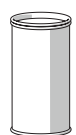

Syntheso Glep 1 grease
Tin 1 kg
for simpler mounting of the pressure ring

Art. No.

105087

Strain relief

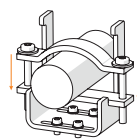

Clamping range 22 to 57
for mounting inside the enclosure

Art. No.

137408

Spare Parts

Hose clamp

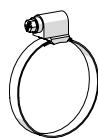

for clamping range 22 to 33 mm

for clamping range 33 to 45 mm

for clamping range 45 to 57 mm

Art. No.

112057

284746

284747

We reserve the right to make alterations to the technical data, dimensions, weights, designs and products available without notice. The illustrations cannot be considered binding.