

8118/113-303 Art. No. 133078



- Resistant Ex e enclosure, universally usable as connection or junction boxes and/or to safeguard electric distributors up to 6.3 A
- IP66 degree of protection
- With mantle terminals or with a combination of mantle terminals and miniature fuses (optional)

MY R. STAHL 8118A



R. STAHL Series 8118 junction boxes are equipped with 4, 5 or 8 mantle terminals depending on their design size. As an option, miniature fuses can still be installed in addition. Junction boxes are therefore also suitable for safeguarding. The robust enclosure made from glass fibre reinforced polyester resin can be equipped with plastic or metal cable glands.

### Technical Data

#### Explosion Protection

Scope of validity	IECEX
Application range (zones)	1 2 21 22
IECEX gas certificate	IECEX PTB 06.0026
IECEX gas explosion protection	Ex e mb IIC T6 / T4 Gb
IECEX dust certificate	IECEX PTB 06.0026
IECEX dust explosion protection	Ex tb IIIC T80 °C / T130 °C Db
ATEX gas certificate	PTB 99 ATEX 3103
ATEX gas explosion protection	⊕ II 2 G Ex e mb IIC T6 / T4 Gb
ATEX dust certificate	PTB 99 ATEX 3103
ATEX dust explosion protection	⊕ II 2 D Ex tb IIIC T80 °C / T130 °C Db
Certificates	ATEX (PTB), Brazil (ULB), China (NEPSI), IECEX (PTB), India (PESO), Korea (KTL)
Declaration of Conformity	ATEX (EUK), China (CCC)
Explosion protection note	For product label, see scope of validity.

#### Electrical Data

Rated operational voltage AC	250 V / 500 V
Rated operational voltage AC	0 ... 250 V
Permissible rated operational current with 5 loaded terminals	For conductor cross-section of 1.5 mm <sup>2</sup> : 13 A For conductor cross-section of 2.5 mm <sup>2</sup> : 18 A For conductor cross-section of 4 mm <sup>2</sup> : 24 A
Permissible rated operational current with 4 loaded terminals	For conductor cross-section of 1.5 mm <sup>2</sup> : 15 A For conductor cross-section of 2.5 mm <sup>2</sup> : 19 A For conductor cross-section of 4 mm <sup>2</sup> : 25 A
Permissible rated operational current with ≤ 3 loaded terminals	For conductor cross-section of 1.5 mm <sup>2</sup> : 16 A For conductor cross-section of 2.5 mm <sup>2</sup> : 20 A For conductor cross-section of 4 mm <sup>2</sup> : 25 A

8118/113-303 Art. No. 133078

### Ambient Conditions

Ambient temperature	-40 °C ... +40 °C (T6) -40 °C ... +55 °C (T4)
---------------------	--

### Mechanical Data

Degree of protection (IP)	IP66
Enclosure material	Polyester resin, Glass fibre reinforced
Permissible number of conductors per clamping unit, solid	Mantle terminal, M7 x 0.75 Conductor cross-section 1.5 mm <sup>2</sup> : Number of conductors min. 2, max. 4 Conductor cross-section 2.5 mm <sup>2</sup> : Number of conductors min. 2, max. 2
Permissible number of conductors per clamping unit, finely stranded prepared, core end sleeve crimped	Mantle terminal M7 x 0.75 Conductor cross-section 1.5 mm <sup>2</sup> : Number of conductors min. 2, max. 3 Conductor cross-section 2.5 mm <sup>2</sup> : Number of conductors min. 2, max. 2
Permissible number of conductors per clamping unit, finely stranded unprepared	Mantle terminal, M7 x 0.75 Conductor cross-section 1.5 mm <sup>2</sup> : Number of conductors min. 2, max. 3 Conductor cross-section 2.5 mm <sup>2</sup> : Number of conductors min. 2, max. 2
Permissible number of conductors per clamping unit note	All conductors of a terminal must have the same cross section and be made of the same material.
Width	85 mm
Height	85 mm
Depth	55 mm
Weight	330 g
Weight	0.73 lb

### Components

Entry 1	2 x Black cable gland M20 Ø 6 ... 13 mm
Entry 2	2 x Stopping plugs M20 x 1,5
Type of terminals 1	3 x Mantle terminal 4 mm <sup>2</sup>

### Technical Drawings – Subject to Alterations

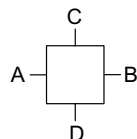

"—" = marking for mounting options

### Dimensional Drawings (All Dimensions in mm [inches]) – Subject to Alterations

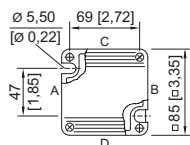
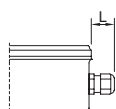
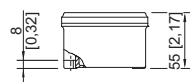



Length L  
Projection dimension for cable gland of Series 8161:  
For M20: 25 to 31 [0.98 to 1.22]  
For M25: 27 to 33 [1.06 to 1.3]  
For M32: 32 to 39 [1.26 to 1.54]  
Projection dimension for cable gland with strain relief of Series HSK-K-MZ  
For M25: 41 [1.61]

8118/1.  
Enclosure SZ 1

8118/113-303 Art. No. 133078

### Accessories

Brass plate with thread		Art. No.
	8118 SZ 1, plate 37 x 30 mm [1.46 x 1.18 inch] 1 x M20 x 1.5 with M4 PE connection (left) Can be installed in enclosures of SZ 1, SZ 2 and SZ 3	168913
	8118 SZ 1, plate 37 x 30 mm [1.46 x 1.18 inch] 1 x M20 x 1.5 with M4 PE connection (right) Can be installed in enclosures of SZ 1, SZ 2 and SZ 3	168914

We reserve the right to make alterations to the technical data, dimensions, weights, designs and products available without notice. The illustrations cannot be considered binding.