

8146/1000-C958 Art. No. 136170



- Cable end boxes for terminals up to 185 mm<sup>2</sup>
- Degree of protection IP66
- Rated operational current depending on enclosure version up to 400 A

MY R. STAHL 8146B



R. STAHL Series 8146 cable end boxes comprise robust glass fibre reinforced Ex e enclosures. They are equipped with terminals up to 185 mm<sup>2</sup>. These are suitable for voltages up to 690 V, the rated operational current is max. 400 A depending on the enclosure version. The incoming and outgoing leads are fed into the enclosures via cable glands.

### Technical Data

#### Explosion Protection

Area of application	IECEX European Union (ATEX)
Application range (zones)	1, 2, 21, 22
IECEX gas certificate	IECEX PTB 06.0046
IECEX gas explosion protection	Ex eb IIC T6 ... T4 Gb
IECEX dust certificate	IECEX PTB 06.0046
IECEX dust explosion protection	Ex tb IIIC T80 °C ... T130 °C Db
ATEX gas certificate	PTB 01 ATEX 1016
ATEX gas explosion protection	⊕ II 2 G Ex eb IIC T6 ... T4 Gb
ATEX dust certificate	PTB 01 ATEX 1016
ATEX dust explosion protection	⊕ II 2 D Ex tb IIIC T80 °C ... T130 °C Db
Certificates	ATEX (PTB), Canada / USA (UL), IECEX (PTB)

#### Electrical Data

Rated operational voltage AC	690 V
Rated operational current max.	125 A / T6 160 A / T5

#### Ambient Conditions

Ambient temperature	-30 °C ... +40 °C (T6) -30 °C ... +45 °C (T5) (T4)
---------------------	---

#### Mechanical Data

IP degree of protection (IEC 60529)	IP66
Enclosure material	Polyester resin, Glass fibre reinforced
Enclosure colour	Dark grey
Flammability according to	IEC/EN 60695 UL 94 ASTM D635
Silicone-free	No
Connection cross-section	70 mm <sup>2</sup>

8146/1000-C958 Art. No. 136170

**Mechanical Data**

Cover thickness	2.8 mm
Cover thickness in inches	0.11 in
Wall thickness	2.8 mm
Wall thickness in inches	0.11 in
Width	340.5 mm
Width, inches	13.406 in
Height	512 mm
Height in inches	20.158 in
Depth	150 mm
Depth in inches	5.906 in
Weight	9.5 kg
Weight	20.94 lb

**Mounting / Installation**

Tightening torque lbf in	0 lbf-in
Tightening torque of cover screw 1	4.5 N · m
Tightening torque of cover screw 1 lbf in	39.83 lbf in

**Components**

Flange and plates	Brass plate
Entry 1	2 x Threaded holes without cable entry M75
Terminal rail	35 x 301 mm (1x)
Terminal rail	1.38 x 11.85" (1x)
Type of terminals 1	6 x Weidmüller WDU 2-conductor, 95 mm <sup>2</sup> , beige
Type of terminals PE 1	2 x Weidmüller WDU 2-conductor 95 mm <sup>2</sup> beige

**Technical Drawings – Subject to Alterations**

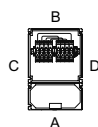

8146/1000-C958 Art. No. 136170

Dimensional Drawings (All Dimensions in mm [inches]) – Subject to Alterations

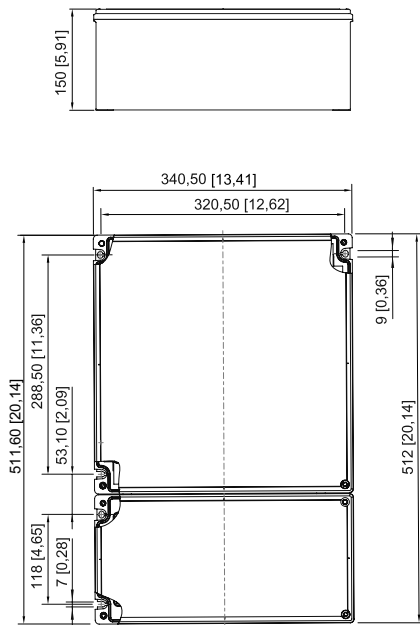

8146/1000-C958

We reserve the right to make alterations to the technical data, dimensions, weights, designs and products available without notice. The illustrations cannot be considered binding.