

Signalling devices



Visual signalling device LED continuous beacon

In flameproof enclosure Increased safety

6161/3-70-121-0-1 Art. No. 219845



- Lamp: Flashing beacon – XENON (5 J)/continuous beacon – LED
- Type of protection: Ex d with Ex e connection chamber
- Class: IP66 (IEC 60529)
- Robust aluminium enclosure (powder-coated)
- Six lens colours can be ordered

MY R. STAHL 6161A



The **6161 product series** can be used as a signal lamp or warning lamp in areas with an explosive gas atmosphere or explosive dust atmosphere.

Technical Data

Explosion Protection

| | |
|---------------------------------|--|
| Area of application | IECEX European Union (ATEX) |
| Application range (zones) | 1, 2, 21, 22 |
| IECEX gas certificate | IECEX EPS 20.0004X |
| IECEX gas explosion protection | Ex db eb IIC T6 Gb |
| IECEX dust certificate | IECEX EPS 20.0004X |
| IECEX dust explosion protection | Ex tb IIIC T65 °C / T75 °C Db |
| ATEX gas certificate | EPS 20 ATEX 1 008 X |
| ATEX gas explosion protection | ⊕ II 2 G Ex db eb IIC T6 Gb |
| ATEX dust certificate | EPS 20 ATEX 1 008 X |
| ATEX dust explosion protection | ⊕ II 2 D Ex tb IIIC T65 °C / T75 °C Db |
| Certificates | ATEX (BVIS), IECEX (BVIS) |
| Declaration of conformity | ATEX (EUK) |

Electrical Data

| | |
|------------------------------|------|
| Rated operational voltage AC | 24 V |
| Rated operational voltage DC | 24 V |
| Back-up fuse | 4 AT |

Lighting Data

| | |
|------|-----|
| Lamp | LED |
|------|-----|

Ambient Conditions

| | |
|---------------------|---|
| Ambient temperature | -40 °C ... +40 °C (T6) -40 °C ... +50 °C |
|---------------------|---|

Mechanical Data

| | |
|---------------------------------------|--|
| Degree of protection (IP) | IP66 |
| Degree of protection (IP) (IEC 60529) | IP66 |
| Enclosure material | Aluminium, powder-coated, Seawater-resistant |
| Enclosure colour | Yellow / black, powder-coated |
| Sealing material | NBR O-ring seal |

Signalling devices



Visual signalling device LED continuous beacon

In flameproof enclosure Increased safety

6161/3-70-121-0-1 Art. No. 219845

Mechanical Data

| | |
|---|---------------------------------|
| Material dome | Polycarbonate (Lexan) Prismatic |
| Wire guard material | Stainless steel |
| Terminal marking | PE + N + L1 |
| Max. solid connection terminals | 4 mm ² |
| Max. finely stranded connection terminals | 2.5 mm ² |
| Clamping range | 4 ... 13 mm |
| Type of connection cable | Solid Finely stranded |
| Width | 76 mm |
| Height | 260 mm |
| Length | 91 mm |
| Lens colour | Yellow |
| Weight | 1.4 kg |
| Weight | 3.09 lb |

Mounting / Installation

| | |
|------------------------|-------------------------------|
| Connection type | Screw terminals, 3-pin |
| Mounting part material | Stainless steel |
| Note about mounting | Can be ordered as accessories |

Components

| | |
|--------------------------|-------------------------------|
| Drilled holes | 2 x M20 |
| Cable glands and entries | 1 x M20 Ø 4 ... 13 mm |
| Material cable gland | Polyamide, black |
| Stopping plugs | 1 x M20 x 1.5 |
| Stopping plug material | Polyamide, black |
| Wire guard | Can be ordered as accessories |

Dimensional Drawings (All Dimensions in mm [inches]) – Subject to Alterations

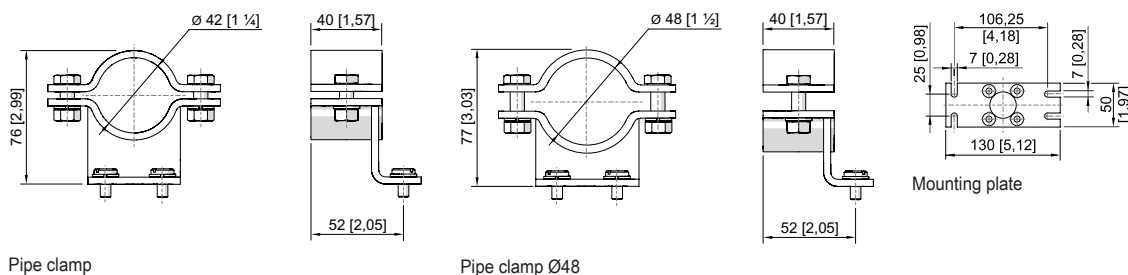
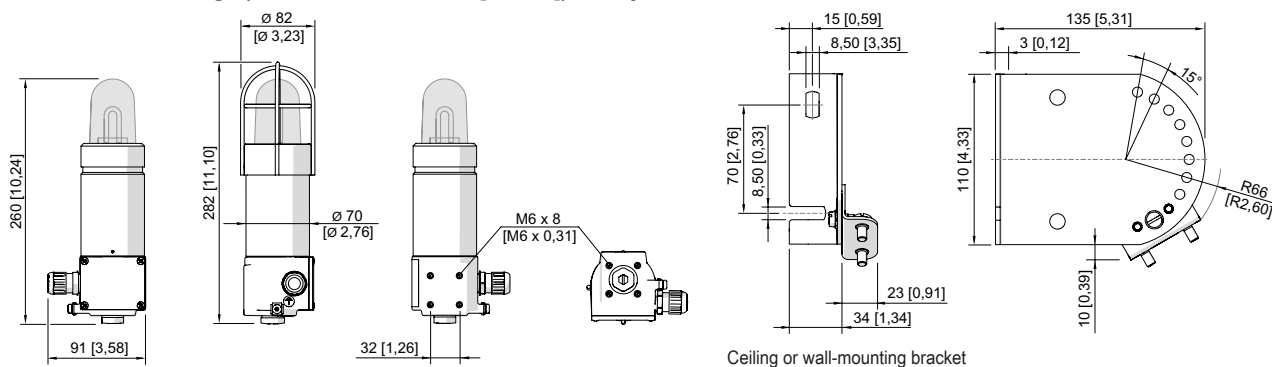

Signalling devices



Visual signalling device LED continuous beacon

In flameproof enclosure Increased safety

6161/3-70-121-0-1 Art. No. 219845

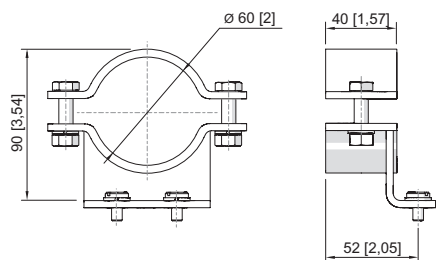

Pipe clamp Ø60

Accessories

Plastic cable gland



8161/7-M20-1304, Ex e
Plastic, M20 x 1.5, cable outer diameter 4 to 13 mm
Lot size 50 pieces

Art. No.

239156

Stopping plug



8290/3-M20
Plastic, M20 x 1.5
Lot size 1 piece

8290/3-M20
Plastic, M20 x 1.5
Lot size 100 pieces

Art. No.

143522

285773

Mounting accessories

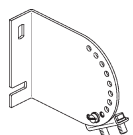

Mounting bracket for wall or floor mounting, stainless steel, incl. mounting screws

Art. No.

120826

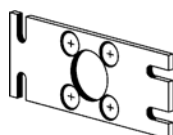

Mounting plate for wall or floor mounting (stainless steel), incl. mounting screws

120821

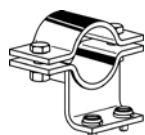

Pipe clamp, R 1 1/4"

Pipe clamp, R 1 1/2"

Pipe clamp, R 2"

120812

120819

120823

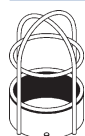

Protective cage, stainless steel

307544

We reserve the right to make alterations to the technical data, dimensions, weights, designs and products available without notice. The illustrations cannot be considered binding.