

8150/0-0176-0176-091-3311-C1923 Art. No. 254055



- Can be used as a terminal or control box
- Corrosion-resistant, low-maintenance, 1.4404 stainless steel
- Can be combined to form a large unit thanks to the modular design of the enclosures

MY R. STAHL 8150C

The R. STAHL Series 8150 Ex e enclosure offers reliable protection for the components installed in it for use as a terminal or control box. It is made of stainless steel, meaning that it is extremely robust and corrosion-resistant, and it requires only minimal maintenance. Thanks to the module structure, they can be combined with each other to form larger units.

Technical Data

Explosion Protection

Area of application	European Union (ATEX) IECEX
Application range (zones)	1, 2, 21, 22
IECEX gas certificate	IECEX PTB 09.0047U
IECEX gas explosion protection	Ex eb IIC Gb
IECEX dust certificate	IECEX PTB 09.0047U
IECEX dust explosion protection	Ex tb IIIC Db
ATEX gas certificate	PTB 09 ATEX 1107 U
ATEX gas explosion protection	⊕ II 2 G Ex eb IIC Gb
ATEX dust certificate	PTB 09 ATEX 1107 U
ATEX dust explosion protection	⊕ II 2 D Ex tb IIIC Db
Certificates	ATEX (PTB), Canada / USA (UL), IECEX (PTB)
Notes	Product label may vary. Series devices are labelled with ATEX and IECEX.

Ambient Conditions

Ambient temperature	-60 °C ... +135 °C
Ambient temperature	-76 °F ... +275 °F
Storage temperature	The storage temperature corresponds to the ambient temperature

Mechanical Data

Degree of protection (IP) (IEC 60529)	IP66
Enclosure material	Stainless steel 1.4404, Brush finished
Silicone-free	No
Cover fixing type	With captive screws
Cover thickness	2 mm
Cover thickness in inches	0.079 in
Wall thickness	1.5 mm
Wall thickness in inches	0.059 in
Width	176.5 mm

8150/0-0176-0176-091-3311-C1923 Art. No. 254055

Mechanical Data

Width, inches	6.949 in
Height	176.5 mm
Height in inches	6.949 in
Depth	91 mm
Depth in inches	3.583 in
Impact strength (IEC 60079)	7 J
Impact strength (IEC 62262)	IK09
Packaging unit	1
Weight	3.7 kg
Weight	8.16 lb

Mounting / Installation

Tightening torque of cover screw 1	4.5 N · m
Tightening torque of cover screw 1 lbf in	39.83 lbf in

Dimensional Drawings (All Dimensions in mm [inches]) – Subject to Alterations

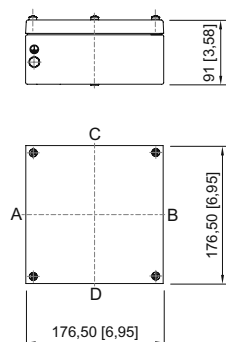

8150/-0176-0176-091-..1.

We reserve the right to make alterations to the technical data, dimensions, weights, designs and products available without notice. The illustrations cannot be considered binding.