



- State-of-the-art LED technology with high luminous efficacy and long service life
- Extremely high luminaire efficacy
- Can be adjusted from a 1.5 to a 3.0 h rated operating time
- Luminous flux after 100,000 h still 90% of the starting luminous flux
- Optionally with DALI for controlling and monitoring the light fitting
- Automatic weekly functional test and annual rated operating time test

### MY R. STAHL 6009D



The emergency luminaire with Series 6009/4 LED with integrated battery can be installed in stand-by switching, continuous mode or in switchable stand-by switching. A weekly functional test and annual rated operating time test are performed automatically. The results are indicated by an LED.

## Technical Data

### Explosion Protection

Ex version	Yes
Application range (zones)	1 2 21 22
IECEX gas certificate	IECEX IBE 16.0038
IECEX gas explosion protection	Ex db eb ib op is IIC T4 Gb
IECEX dust certificate	IECEX IBE 16.0038
IECEX dust explosion protection	Ex tb op is IIIC T100 °C Db
ATEX gas certificate	IBExU 16 ATEX 1199
ATEX gas explosion protection	⊕ II 2 G Ex db eb ib op is IIC T4 Gb
ATEX dust certificate	IBExU 16 ATEX 1199
ATEX dust explosion protection	⊕ II 2 D Ex tb op is IIIC T100 °C Db
Certificates and approvals	ATEX IECEX
Certificates	ATEX (IBE), IECEX (IBE), Polen (CNBOP)
Ship approval	DNV
Declaration of Conformity	ATEX (EUK), Declaration of Conformity (AUS)

### Electrical Data

Rated operational voltage AC	100 – 240 V
Battery version	NiCd battery, gas-tight
Battery operating voltage	6 V
Battery capacity	7 Ah
Self-test function	With (standard)
Frequency range	50 – 60 Hz

### Lighting Data

Number of lamps	1
Lamp wattage	25 W

# Lighting

## Emergency luminaire With LED

### GRP

6009/4128-2103-162-1110-11-850011 Art. No. 267867



#### Lighting Data

Lamp	LED
Light colour	5000 K – neutral white
Light distribution	120°x120° with diffusing glass
Luminaire efficacy	116 lm/W
Luminous flux	2910 lm
Operating time	1.5 / 3h emergency lighting operation
Emergency light output	35% – 3 h 65% – 1.5 h
Colour rendering	≥ 80
Colour temperature	5000 K

#### Ambient Conditions

Ambient temperature	-30 °C ... +50 °C Note: Through wiring Max. 3x16 A -30 °C ... +55 °C Note: Through wiring 2 Max. 3x10 A
---------------------	--

#### Mechanical Data

Version	Standard
IP degree of protection (IEC 60598)	IP66/IP67
Enclosure material	Polyester resin, Glass fibre reinforced
Enclosure colour	Light grey (RAL 7035)
Diffuser	With diffuser
Sealing material	Silicone
Silicone-free content	Contains silicone
Translucent cover material	Polycarbonate
Installed terminal strip	PE + N + L1 + L2 + L3 + L´
Max. solid connection terminals	6 mm <sup>2</sup>
Max. finely stranded connection terminals	4 mm <sup>2</sup>
Type of connection cable	Finely stranded Solid
Size	2
Width	183.5 mm
Height	125 mm
Length	857 mm
Impact strength (IEC 62262)	IK10
Weight	6.65 kg
Weight	14.66 lb
Disconnection of the luminaire	All-pole disconnection

#### Components

Threaded plate	2x plastic
Ballast	6046/311-121-010
Through wiring	With 6 conductors 2.5 mm <sup>2</sup>
Drilled holes	3 x M25
Cable glands and entries	2 x M25 Ø 7 ...
Material cable gland	Polyamide, black
Stopping plugs	2 x M25 x 1.5
Stopping plug material	Polyamide, black
Accessories	Provided

# Lighting

## Emergency luminaire With LED

### GRP

6009/4128-2103-162-1110-11-850011 Art. No. 267867



#### Dimensional Drawings (All Dimensions in mm [inches]) – Subject to Alterations

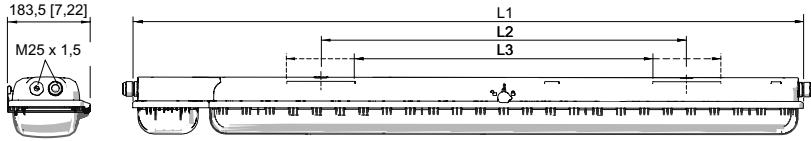

Size 2:  
 L1 = 857 mm [33.74]  
 L2 = 400 mm [15.75]  
 L3 = 320 ... 480 mm [12.60 ... 18.90]

Size 4:  
 L1 = 1467 mm [57.76]  
 L2 = 800 mm [31.50]  
 L3 = 670 ... 930 mm [26.38 ... 36.61]

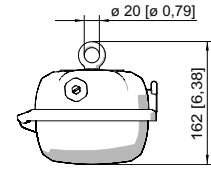
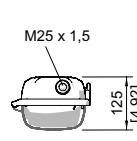

Ring bolt fitted in insert nut of the luminaire

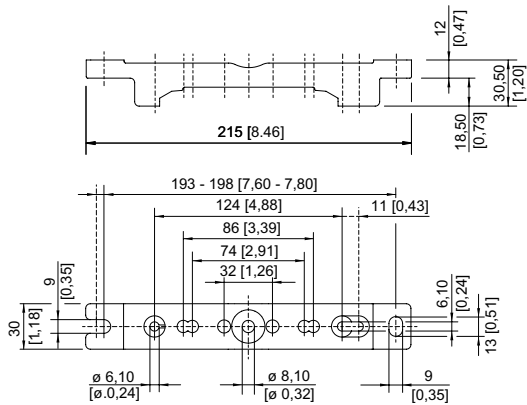

Mounting rail

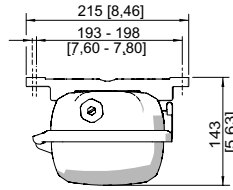

Mounting rail

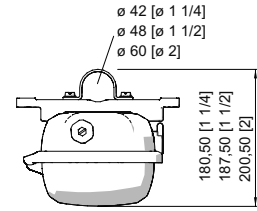

Pipe clamp fitted in mounting rail

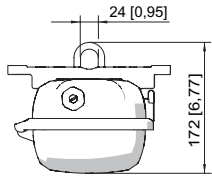

Mounting bracket fitted in mounting rail

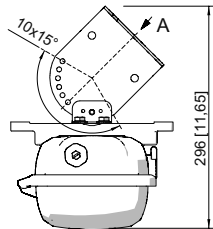

A

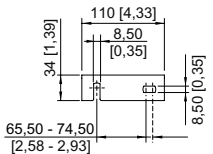

Wall mounting bracket fitted in mounting rail

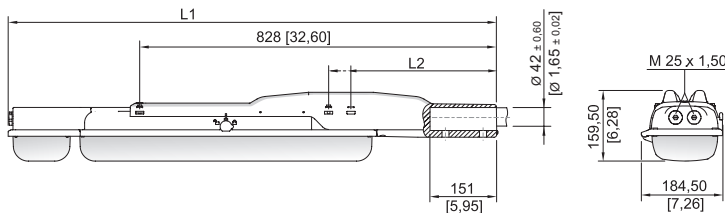

With pole mounting sleeve  
 Size 2:  
 L1 = 1133 mm [44.61]  
 L2 = 390 mm [15.35]

Size 4:  
 L1 = 1742 mm [68.58]  
 L2 = 338 mm [13.31]

## Accessories



# Lighting

## Emergency luminaire With LED

GRP

6009/4128-2103-162-1110-11-850011 Art. No. 267867

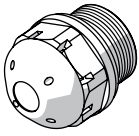
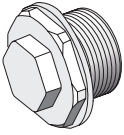
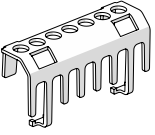
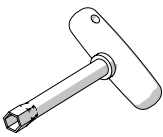
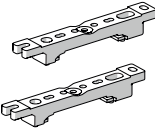
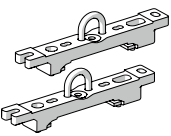
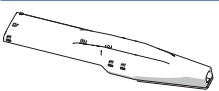
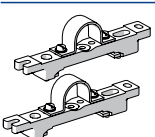
STAHL

Breather		Art. No.
	Thread: M25 x 1.5 (20 pieces); without jam nut	285780
	Thread: M25 x 1.5 (1 piece); for installation in light fittings; made from stainless steel; without jam nut	296608
Protection against accidental contact		Art. No.
	The protection against accidental contact prevents maintenance technicians and electrical installers from accidentally touching conductive parts. The degree of protection is increased to IP20 when the protection against accidental contact is used.	283153
Box spanner		Art. No.
	M8 / A/F 13; For actuating the central lock	222430
Mounting rail		Art. No.
	for a variable mounting distance; 1 pair	222826
Mounting bracket		Art. No.
	mounting clamp mounted on a mounting rail for a variable mounting distance; 1 pair	222456
Pole mounting sleeve		Art. No.
	for the subsequent mounting on lights size 2 and size 4, completely with assembly parts (for pipe diameter 42 mm)	227512
Pipe clamp		Art. No.
	R 1 1/2"; with mounting rail for a variable mounting distance; material: stainless steel; 1 pair	222459
	R 1 1/4"; with mounting rail for a variable mounting distance; Material: stainless steel; 1 pair	222458
	R 2"; with mounting rail for a variable mounting distance; Material: stainless steel; 1 pair	222460
Ring bolt		Art. No.
	M8, direct mounting in insert nuts; 1 pair	115736

# Lighting

## Emergency luminaire With LED

GRP

6009/4128-2103-162-1110-11-850011 Art. No. 267867



### Breather

Art. No.

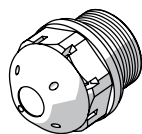

Thread: M25 x 1.5; 20 pc; for installation in lights; in moulded material; without counter nut  
M25 x 1.5 in order to avoid condensate formation

138576

115738

### Ceiling and wall mounting bracket

Art. No.

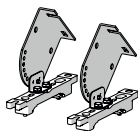

mounted on a mounting rail for a variable mounting distance; Material: stainless steel; Lamp can be swiveled in steps of 15°; 1 pair

222827

## Spare Parts

### Cover

Art. No.

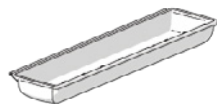

for luminaire size 2

222427

### Contact element

Art. No.

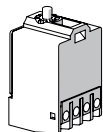

8080/1-3-L 2 NC contact element

132527

### Battery set

Art. No.

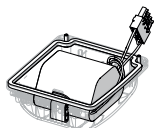

Battery cover with built-in battery. Gas-tight NiCd battery; 7 Ah / 6 V

223532

We reserve the right to make alterations to the technical data, dimensions, weights, designs and products available without notice. The illustrations cannot be considered binding.