

Control Devices

Contact element For front installation NO

With gold-plated contacts

8082/3-21-2-1 Art. No. 273167

STAHL



- Large selection of different actuators
- Versions as an NC with positive opening, NO or disconnect terminal

MY R. STAHL 8082D



R. STAHL Series 8082 contact elements have an NO contact and a positive opening operation NC contact, made from silver-nickel or gold-plated. They can be easily combined with contact blocks and enable customised installations, also due to the large selection of the various actuators.

Technical Data

Explosion Protection

| | |
|--------------------------------|---|
| Scope of validity | European Union (ATEX) CEC IECEX NEC |
| Application range (zones) | 1 2 |
| IECEX gas certificate | IECEX PTB 17.0037U |
| IECEX gas explosion protection | Ex db eb IIC T6 / T5 Gb |
| IECEX firedamp certificate | IECEX PTB 17.0037U |
| IECEX firedamp protection | Ex db eb I Mb |
| ATEX gas certificate | PTB 17 ATEX 1012 U |
| ATEX gas explosion protection | Ex II 2 G Ex db eb IIC T6 / T5 Gb |
| ATEX firedamp certificate | PTB 17 ATEX 1012 U |
| ATEX firedamp protection | Ex I M2 Ex db eb I Mb |
| UL gas certificate | E182378V1S9 |
| Marking cULus | Class I, Div. 2, Groups A,B,C,D; Class I, Zone 1, AEx/Ex db eb IIC |
| Certificates | ATEX (PTB), Brazil (ULB), Canada (UL), China (CQST), IECEX (PTB), Korea (KTL), USA (UL) |
| Notes | Product label may vary. Series devices are labelled with ATEX, IECEX, NEC and CEC. |

Electrical Data

| | |
|--------------------------------|---|
| Max. rated operational voltage | 550 V |
| Min. rated operational voltage | 24 V |
| Rated operational current | 10 mA / 150 A |
| Rated operational current note | - Gold-plated contacts: 10 to 150 mA switching current - Silver-nickel contacts from 150 mA switching current. - For corrosive environments and offshore applications, we recommend the use of 8082 snap action switches. |
| Electrical service life | 10 ⁹ operating cycles |

Control Devices

Contact element For front installation NO

With gold-plated contacts

8082/3-21-2-1 Art. No. 273167

STAHL

Electrical Data

| | |
|-------------------------|----------------------------------|
| Mechanical service life | 10 ⁶ operating cycles |
|-------------------------|----------------------------------|

Ambient Conditions

| | |
|---------------------|--|
| Ambient temperature | -60 °C ... +70 °C (T6) -60 °C ... +85 °C (T5) |
|---------------------|--|

| | |
|---------------------|--|
| Ambient temperature | -76 °F ... +158 °F (T6) -76 °F ... +185 °F (T5) |
|---------------------|--|

| | |
|--------------------------|--|
| Ambient temperature NEC® | -60 °C ... +75 °C (T6) -60 °C ... +90 °C (T5) |
|--------------------------|--|

| | |
|--------------------------|--|
| Ambient temperature NEC® | -76°F ... +167°F (T6) -76°F ... +194°F (T5) |
|--------------------------|--|

| | |
|-----------------------|--------------------|
| Operating temperature | -60 °C ... +100 °C |
|-----------------------|--------------------|

| | |
|-----------------------|--------------------|
| Operating temperature | -76 °F ... +212 °F |
|-----------------------|--------------------|

| | |
|---------------------------|-------------------|
| Operating temperature NEC | -60 °C ... +95 °C |
|---------------------------|-------------------|

| | |
|---------------------------|--------------------|
| Operating temperature NEC | -76 °F ... +203 °F |
|---------------------------|--------------------|

Mechanical Data

| | |
|---------------------------------------|------|
| Degree of protection (IP) (IEC 60529) | IP20 |
|---------------------------------------|------|

| | |
|--------------------|-----------|
| Enclosure material | Polyamide |
|--------------------|-----------|

| | |
|------------------|-------------|
| Contact material | Gold-plated |
|------------------|-------------|

| | |
|---------------|-----|
| Silicone-free | Yes |
|---------------|-----|

| | |
|--|---------------------|
| Max. connection cross-section, finely stranded | 2,5 mm ² |
|--|---------------------|

| | |
|--------------------------------|----------------------------|
| Solid connection cross section | 0.32 – 2.5 mm ² |
|--------------------------------|----------------------------|

| | |
|--|------------------|
| Connection cross-section AWG single stranded | 22 AWG to 14 AWG |
|--|------------------|

| | |
|--|----------------------------|
| Finely stranded connection cross section | 0.32 – 2.5 mm ² |
|--|----------------------------|

| | |
|--|------------------|
| Finely stranded connection cross-section AWG | 22 AWG to 14 AWG |
|--|------------------|

| | |
|--|----------------------------|
| Connection cross-section, finely stranded with core end sleeve | 0.32 – 2.5 mm ² |
|--|----------------------------|

| | |
|--|---------------|
| Connection cross-section, finely stranded with core end sleeve AWG | AWG22 - AWG14 |
|--|---------------|

| | |
|---------------|---|
| Number of NOs | 1 |
|---------------|---|

| | |
|----------|------|
| Contacts | 1 NO |
|----------|------|

| | |
|----------------|---|
| Packaging unit | 1 |
|----------------|---|

| | |
|--------|------|
| Weight | 25 g |
|--------|------|

| | |
|--------|----------|
| Weight | 0.055 lb |
|--------|----------|

Mounting / Installation

| | |
|-------------------|--------|
| Tightening torque | 1.2 Nm |
|-------------------|--------|

| | |
|--------------------------|--------------|
| Tightening torque lbf in | 10.62 lbf in |
|--------------------------|--------------|

| | |
|-----------------|----------------|
| Connection type | Screw terminal |
|-----------------|----------------|

Control Devices

Contact element For front installation NO

With gold-plated contacts

8082/3-21-2-1 Art. No. 273167



Dimensional Drawings (All Dimensions in mm [inches]) – Subject to Alterations

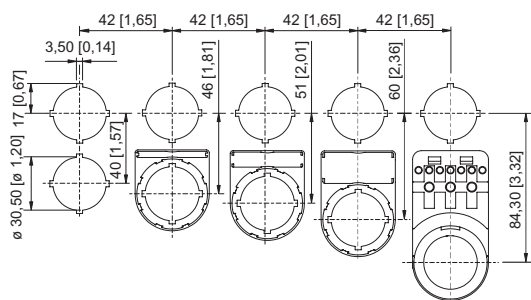
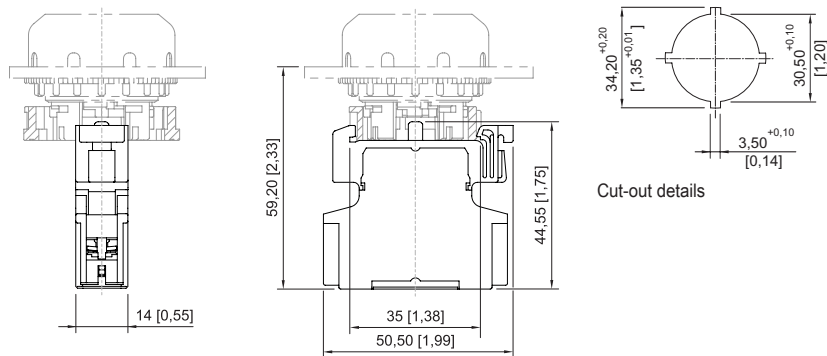

Cut-out with/without additional designation plate

Accessories

Pushbutton BG001



Ø 39 mm
Black
Designation plate: Black, blank disc without text
Silicone-free: Yes

Art. No.

223691

Ø 39 mm
Black
Designation plate: Black, blank disc without text
Silicone-free: No

223692

Mushroom pushbutton, black

BG003



Ø 39 mm
Black
Designation plate: Black, blank disc without text
Silicone-free: Yes

Art. No.

244563

Ø 39 mm
Black
Designation plate: Black, blank disc without text
Silicone-free: No

244564

Control Devices

Contact element For front installation NO

With gold-plated contacts

8082/3-21-2-1 Art. No. 273167

Mushroom pushbutton, red

| | | Art. No. |
|--|---|----------|
|  | Ø 39 mm Red/black Designation plate: Red, blank disc without text Silicone-free: Yes | 244565 |
| | Ø 39 mm Red/black Designation plate: Red, blank disc without text Silicone-free: No | 244566 |

Mushroom stay-put button with key

| | | Art. No. |
|--|--|----------|
|  | Ø 39 mm Red/black Closing: MS1 Silicone-free: Yes | 223695 |
| | Ø 39 mm Red/black Closing: MS1 Silicone-free: No | 223696 |

Key-operated switch actuator

| | | Art. No. |
|--|---|----------|
|  | Ø 39 mm Black Closing: MS1 Number of switching positions: 2 Switching function: Latching / Latching Silicone-free: No | 244574 |
| | Ø 39 mm Black Closing: MS1 Number of switching positions: 3 Switching function: Latching / Latching / Latching Silicone-free: No | 244633 |

Mushroom stay-put button with EM-STOP key

| | | Art. No. |
|--|---|----------|
|  | Ø 39 mm Yellow/red Designation plate: With yellow backing plate Closing: MS1 Silicone-free: Yes | 223693 |
| | Ø 39 mm Yellow/red Designation plate: With yellow backing plate Closing: MS1 Silicone-free: No | 223694 |

Control Devices

Contact element For front installation NO

With gold-plated contacts

8082/3-21-2-1 Art. No. 273167

STAHL

Mushroom stay-put button EM-STOP

| | | Art. No. |
|--|---|----------|
|  | Ø 39 mm Yellow/red Designation plate: With yellow backing plate Silicone-free: Yes | 223697 |
| | Ø 39 mm Yellow/red Designation plate: With yellow backing plate Silicone-free: No | 223698 |

Mushroom stay-put button, black

| | | Art. No. |
|--|--|----------|
|  | Ø 39 mm Black Silicone-free: Yes | 223699 |
| | Ø 39 mm Black Silicone-free: No | 223700 |

Mushroom pushbutton, 55 mm, red

| | | Art. No. |
|---|---|----------|
|  | Ø 55 mm Black/red Designation plate: Red, blank disc without text Silicone-free: Yes | 244634 |
| | Ø 55 mm Black/red Designation plate: Red, blank disc without text Silicone-free: No | 244635 |

Mushroom stay-put button, 55 mm, EM-STOP

| | | Art. No. |
|--|---|----------|
|  | Ø 55 mm Yellow/red Designation plate: With yellow backing plate Silicone-free: Yes | 244636 |

Mushroom stay-put button 55 mm EM-STOP

| | | Art. No. |
|--|--|----------|
|  | Ø 55 mm Yellow/red Designation plate: With yellow backing plate Silicone-free: No | 244637 |

Twin pushbutton

| | | Art. No. |
|--|-----------------------------|----------|
|  | Black Silicone-free: Yes | 244638 |
| | Black Silicone-free: No | 244639 |

Control Devices

Contact element For front installation NO

With gold-plated contacts

8082/3-21-2-1 Art. No. 273167

STAHL

Mushroom pushbutton, 55 mm, black

| | | Art. No. |
|--|---|----------|
|  | Ø 55 mm Black Designation plate: Black, blank disc without text Silicone-free: Yes | 244642 |
| | Ø 55 mm Black Designation plate: Black, blank disc without text Silicone-free: No | 244643 |

Small rotary actuator, not lockable

| | | Art. No. |
|--|--|----------|
|  | Ø 39 mm Black Designation plate: 0/OFF – I/ON Number of switching positions: 2 Lockable in: Not padlockable Switching function: Latching / Latching Silicone-free: Yes | 244646 |

Small rotary actuator, not lockable

| | | Art. No. |
|--|---|----------|
|  | Ø 39 mm Black Designation plate: 0/OFF – I/ON Number of switching positions: 2 Lockable in: Not padlockable Switching function: Latching / Latching Silicone-free: No | 244647 |

Small rotary actuator, not lockable

| | | Art. No. |
|--|---|----------|
|  | Ø 39 mm Black Designation plate: I – 0 – II Number of switching positions: 3 Lockable in: Not padlockable Switching function: Latching / Latching / Latching Silicone-free: Yes | 244648 |
| | Ø 39 mm Black Designation plate: I – 0 – II Number of switching positions: 3 Lockable in: Not padlockable Switching function: Latching / Latching / Latching Silicone-free: No | 244649 |

Control Devices

Contact element For front installation NO

With gold-plated contacts

8082/3-21-2-1 Art. No. 273167

STAHL

Rotary actuator, small, lockable

| | | Art. No. |
|--|--|----------|
|  | Ø 39 mm Black Designation plate: 0/OFF – I/ON Number of switching positions: 2 Lockable in: One pos. with one lock Switching function: Latching / Latching Silicone-free: Yes | 244650 |
| | Ø 39 mm Black Designation plate: 0/OFF – I/ON Number of switching positions: 2 Lockable in: One pos. with one lock Switching function: Latching / Latching Silicone-free: No | 244651 |
|  | Ø 39 mm Black Designation plate: I – 0 – II Number of switching positions: 3 Lockable in: One pos. with one lock Switching function: Latching / Latching / Latching Silicone-free: Yes | 244652 |
| | Ø 39 mm Black Designation plate: I – 0 – II Number of switching positions: 3 Lockable in: One pos. with one lock Switching function: Latching / Latching / Latching Silicone-free: No | 244653 |

Illuminated pushbutton (spring return)

| | | Art. No. |
|--|---|----------|
|  | Ø 39 mm Black All colours Silicone-free: Yes | 244654 |
| | Ø 39 mm Black All colours Silicone-free: No | 244655 |

Spare Parts

Mushroom stay-put button with key

| | Art. No. |
|--|----------|
|--|----------|

Control Devices

Contact element For front installation NO

With gold-plated contacts

8082/3-21-2-1 Art. No. 273167



| | |
|--|--------|
| Ø 39 mm Red/black Closing: MS2 Silicone-free: Yes | 270409 |
| Ø 39 mm Red/black Closing: MS2 Silicone-free: No | 270412 |
| Ø 39 mm Red/black Closing: MS3 Silicone-free: Yes | 270410 |
| Ø 39 mm Red/black Closing: MS3 Silicone-free: No | 270413 |
| Ø 39 mm Red/black Closing: MS4 Silicone-free: Yes | 270411 |
| Ø 39 mm Red/black Closing: MS4 Silicone-free: No | 270414 |

Control Devices

Contact element For front installation NO

With gold-plated contacts

8082/3-21-2-1 Art. No. 273167

Key-operated switch actuator

BG008

Art. No.

| | | Art. No. |
|--|---|----------|
|  | Ø 39 mm Black Closing: MS1 Number of switching positions: 2 Switching function: Latching / Latching Silicone-free: Yes | 244573 |
| | Ø 39 mm Black Closing: MS2 Number of switching positions: 2 Switching function: Latching / Latching Silicone-free: Yes | 272935 |
| | Ø 39 mm Black Closing: MS2 Number of switching positions: 2 Switching function: Latching / Latching Silicone-free: No | 270418 |
| | Ø 39 mm Black Closing: MS3 Number of switching positions: 2 Switching function: Latching / Latching Silicone-free: Yes | 274089 |
| | Ø 39 mm Black Closing: MS3 Number of switching positions: 2 Switching function: Latching / Latching Silicone-free: No | 270419 |
| | Ø 39 mm Black Closing: MS4 Number of switching positions: 2 Switching function: Latching / Latching Silicone-free: Yes | 272936 |
| | Ø 39 mm Black Closing: MS4 Number of switching positions: 2 Switching function: Latching / Latching Silicone-free: No | 270420 |

Control Devices

Contact element For front installation NO

With gold-plated contacts

8082/3-21-2-1 Art. No. 273167



| | | |
|--|--|--------|
|  | Ø 39 mm Black Closing: MS1 Number of switching positions: 3 Switching function: Latching / Latching / Latching Silicone-free: Yes | 244632 |
| | Ø 39 mm Black Closing: MS2 Number of switching positions: 3 Switching function: Latching / Latching / Latching Silicone-free: Yes | 274090 |
| | Ø 39 mm Black Closing: MS2 Number of switching positions: 3 Switching function: Latching / Latching / Latching Silicone-free: No | 270421 |
| | Ø 39 mm Black Closing: MS3 Number of switching positions: 3 Switching function: Latching / Latching / Latching Silicone-free: Yes | 274091 |
| | Ø 39 mm Black Closing: MS3 Number of switching positions: 3 Switching function: Latching / Latching / Latching Silicone-free: No | 270422 |
| | Ø 39 mm Black Closing: MS4 Number of switching positions: 3 Switching function: Latching / Latching / Latching Silicone-free: Yes | 274092 |
| | Ø 39 mm Black Closing: MS4 Number of switching positions: 3 Switching function: Latching / Latching / Latching Silicone-free: No | 270423 |

Control Devices

Contact element For front installation NO

With gold-plated contacts

8082/3-21-2-1 Art. No. 273167

Mushroom stay-put button with EM-STOP key

| | | Art. No. |
|--|---|----------|
|  | Ø 39 mm Yellow/red Designation plate: With yellow backing plate Closing: MS2 Silicone-free: Yes | 274099 |
| | Ø 39 mm Yellow/red Designation plate: With yellow backing plate Closing: MS2 Silicone-free: No | 270415 |
| | Ø 39 mm Yellow/red Designation plate: With yellow backing plate Closing: MS3 Silicone-free: Yes | 274100 |
| | Ø 39 mm Yellow/red Designation plate: With yellow backing plate Closing: MS3 Silicone-free: No | 270416 |
| | Ø 39 mm Yellow/red Designation plate: With yellow backing plate Closing: MS4 Silicone-free: Yes | 274101 |
| | Ø 39 mm Yellow/red Designation plate: With yellow backing plate Closing: MS4 Silicone-free: No | 270417 |

Adaptor for front installation

| | | Art. No. |
|--|--|----------|
|  | 8602/3 Front installation for indicator lamp series 8010/6 and contact element series 8082/3 | 227038 |

Holder for front installation

| | | Art. No. |
|--|------------------------------|----------|
|  | 8602/3 holder for cable duct | 248673 |

We reserve the right to make alterations to the technical data, dimensions, weights, designs and products available without notice. The illustrations cannot be considered binding.